

SWINDON TOWN

OFFICIAL CLUB SPONSOR LOWNDES LAMBERT

OFFICIAL PROGRAMME 70P

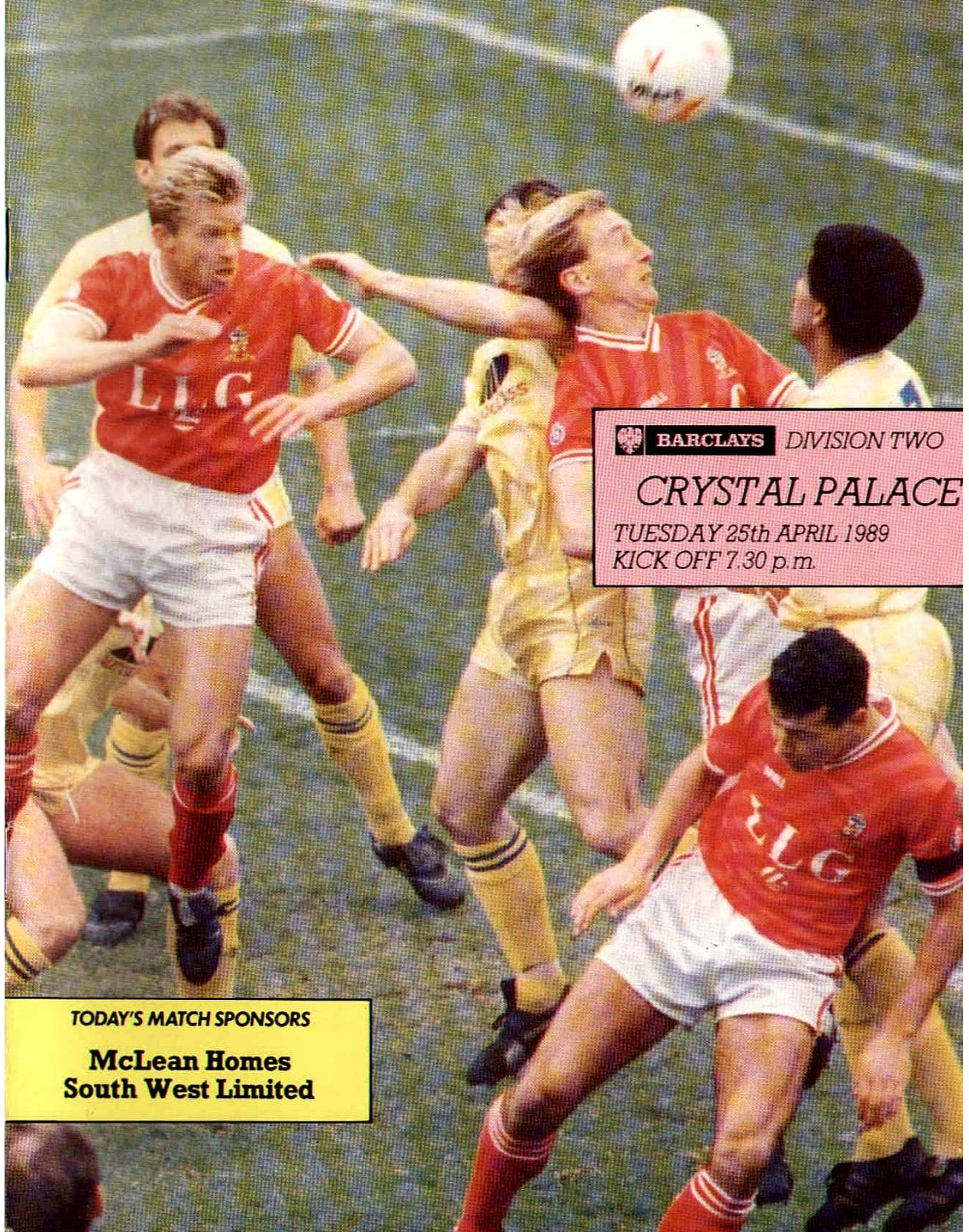

BARCLAYS

DIVISION TWO

CRYSTAL PALACE

TUESDAY 25th APRIL 1989

KICK OFF 7.30 p.m.

TODAY'S MATCH SPONSORS

**McLean Homes
South West Limited**

A continuing partnership



Lowndes Lambert Group
are happy to continue their support
as main sponsors of
Swindon Town Football Club



Lowndes Lambert Group Ltd
Aspen House
Temple Street
Swindon Tel: 26252

WORLDWIDE INSURANCE PROTECTION FOR INDUSTRY & COMMERCE

**SWINDON TOWN
FOOTBALL CO. LTD.**

Telephone (0793) 642984 (5 lines)

Registered Office:
COUNTY GROUND, SWINDON

President:

MR. W. J. CASTLE

Chairman:

B. HILLIER

Vice Chairman:

G. W. HERBERT

Directors:

D. ALDERTON

N. ARKELL

C. J. GREEN

C. HOWARD

T. J. KEARSEY

R. MATTICK

L. SMART

Administration Manager/Club Secretary:

D. G. KING

Manager:

LOU MACARI

Assistant Manager:

JOHN TROLLOPE

Coaches:

ANDY ROWLAND

CHIC BATES

Accountant/Company Secretary:

V. F. FARRAR

Commercial Manager:

DOUG BUSWELL

Club Physiotherapist:

KEVIN MORRIS

Club Chaplain:

REV. NIGEL SANDS

Programme Editor:

DAVE KING

Design:

EDDY SHUREY

Typesetting:

T.S. TYPESETTING

Artwork:

ROBERT BROWN

Printing:

THAMESDOWN LITHO

All contributions published in this programme do not necessarily reflect the view of Swindon Town Football Club.

HONOURS

Division 3 Promotion

Play-Off Winners: 1986/87

Division Four Champions: 1985/86

Football League Cup

Winners: 1969

Semi-Finalists: 1980

Anglo Italian

Cup Winners: 1970

International League Cup

Winners Cup

Winners: 1969

Division Three Runners Up: 1962-63, 1968-69

F.A. Charity Shield Finalists: 1911

F.A. Youth Cup Finalists: 1964

F.A. Cup Semi-Finalists: 1910, 1912



NO TEAM IS PERFECT

The race for a place in the play-offs is on again. I know most people were somewhat pessimistic about our chances after we had been held to a draw here at the County Ground by Watford.

I could not subscribe to that view because points are always going to be dropped. No team is perfect. We bounced back with the expected victory at Birmingham City and we now have the Clubs above us in the League table within our sights once again.

WE CAN END THE PALACE 'RUN'

We have had several matches recently where we have been involved in virtual 'six point' encounters. Once again we face such a situation this evening.

Our record against Crystal Palace in the last two seasons has not been too good. That record will end and if we apply ourselves to the task of blotting out Ian Wright and Mark Bright. I am sure we can defeat Crystal Palace.

THANK YOU ARGYLE

Our remaining fixture list is probably one of the easier of the teams vying for the play-offs. Visits to Walsall and Oldham Athletic who are in the lower reaches of the Division. Home fixtures against Shrewsbury, who are near the bottom of the table, and a home match against inconsistent

**THE
MANAGER'S
VIEW**

BY

Lou Macari

Stoke City should give us the lift and points required.

Plymouth Argyle's draw at West Bromwich Albion on the day we were held to a draw by Watford gave us a life-line. West Brom faced three away matches in their last five fixtures and we had an even balance after the away match at Birmingham City.

JUST ENOUGH

Reviewing the match at Birmingham City we fell away in the second half and gave a tepid display. The young Birmingham team came more into the game.

Our 2-0 interval lead was enough to see us take the three points and so move nearer the leaders. It was a difficult game, no atmosphere, a dull pitch and relegated opposition. It was a match that I was glad to see over. I spent the last ten minutes anxiously watching the clock.

**HELP SANDRA AND THE HELPERS
PLEASE**

This evening Miss Sandra Coburn, the Secretary of the Supporters Club, and her helpers will be asking you to donate to the Hillsborough disaster fund.

Please help them to swell this most worthy cause. The tragedy needs no words of explanation. Sympathy is enough.

SWINDON SUPPORTERS IN LONDON

Nick Coote 01-828 3651 and Paul Donkersly 01-730 3456
Sponsor Lou Macari's kit.

Hill House Hammond the right choice for your insurance.

Tel: Swindon 618158.

Better by Burmah

Burmah Petroleum Fuels Limited is proud to support Swindon Town Football Club and offers a warm welcome to all supporters at:

Swindon Autopoint
Marlborough Road, Swindon

Newport Street Autopoint
Newport Street
Old Town, Swindon

Stratton Autopoint
67 Bridgend Road
Stratton St Margaret, Swindon

St. Margarets Garage
Highworth Road
Stratton St. Margaret, Swindon

Swindon Automobiles
Dorcan Way, Swindon

Blagrove Autopoint
Great Western Way, Swindon

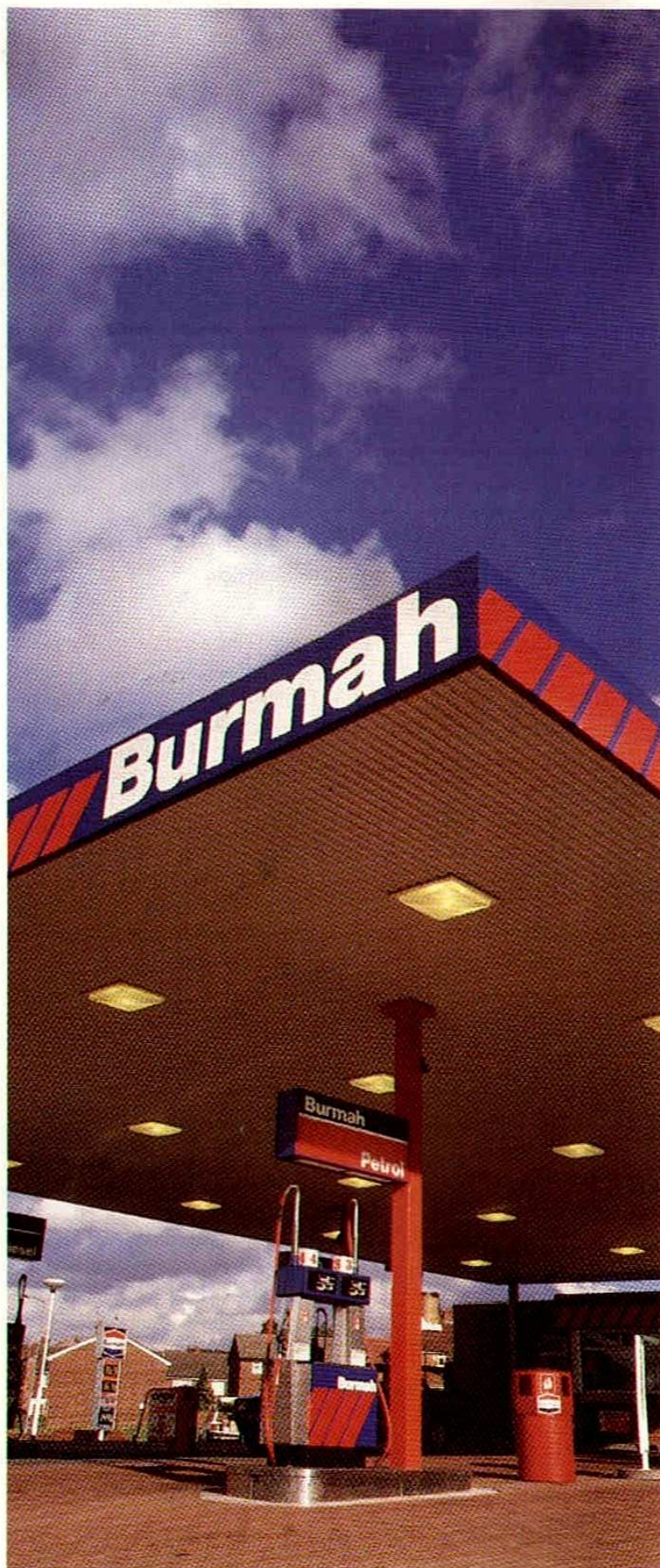

WHY DON'T THEY LISTEN?

One of the many lessons to be learned from the wholly preventable Hillsborough tragedy is that the fans voice must be heard in the future, years of contempt by politicians and football authorities have been highlighted in the most awful way imaginable.

Hundreds of fans have predicted that fences could result in a disaster, but their opinions have never been considered to carry any importance.

OUTLIVED ITS PURPOSE

The standard of policing at Hillsborough appears to be the major issue, although attempts to cloud the issue with the many other problems at the Semi-Final provoke immediate thoughts of a cover up. Given adequate and effective police action of the kind employed at numerous big matches and the identical Semi-Final a year ago, there would have been no crush at the turnstiles. Given better crowd control policies in general, there would be no need for any fencing within football grounds. Changes in crowd behaviour and detection techniques have made fencing a prevention measure which has outlived its useful life considering the number of instances of hooliganism within football grounds.

WE ARE NOT SUBHUMAN

The aggressive herding of fans like distasteful subhumans into compact pens has been something to endure for many years and itself breeds an aggressive reaction, a little more understanding and a more reasonable attitude from some policemen would be a major step forward in crowd control. If eight hundred police on duty at Hillsborough cannot cope, then something is seriously wrong with their crowd control policy. Perhaps if more thoughtful planning in the build up to the Semi-Final, rather than banning inflatables, had been

SCOTT FREE



by Michael Scott

on the agenda, then nearly one hundred deaths could have been avoided.

POLICE AN ASSET TO CLUBS

The few trips I have made to Highbury have convinced me that all policing need not be heavy-handed. Given adequate organisation in and around the stadium, the police are an asset to football Clubs and fans alike. The events at Hillsborough were not an isolated example of thoughtless policing but neither were they typical of every force's technique. Much more consideration must be given to the fans, the most important people on any match day.

POLITICAL PRIDE COMES FIRST

The Government's perseverance with their ill fated I.D. Card Bill is totally sickening, if not unexpected, in the light of the disaster in Sheffield. To put political pride before common sense and safety is an incredible reaction to a tragedy that would probably have been worse with I.D. cards further clog-

ging the flow of fans. The best political reaction would be to forget the Bill altogether and instead be prepared to take on board the recommendations of the Taylor inquiry.

NEW DEPTHS

Media coverage of the disaster has plumbed new depths, with saturation in both the papers and television. There seems to have been no restraint whatsoever in the choice of photographs for publication. The Sun seems to glory in any disaster but the Daily Mirror's lurid photographs have been just as bad. Who wants to view every intimate detail of such a personal tragedy? Even the Evening Advertiser felt that it was right to publish a half page picture of fans crushed against the fence, saying that it conveyed more than words ever could. Why then, after a weekend of solid media coverage, did the paper also devote thousands of words to the tragedy? The general media attitude seems to suggest that by covering the event in such microscopic detail, they are giving the reader what they want, yet more evidence of the all-important public being ignored.

FOOTBALL IS UNIMPORTANT COMPARED TO LIFE

No good can come from such a terrible situation but measures must be taken to ensure that it proves to be a one-off tragedy. No amount of sympathy can help those directly involved, but all contributing factors must come out into the open in order that corrective action can be taken. Football immediately became unimportant following Hillsborough as tragedy brought real priorities into focus. The game must stay out of the limelight for long enough to ensure that supporters can express their views on the game's long term future as a safe spectator sport.

Up to 60% discount for wives driving the second car.

Tel: Swindon 618158.

SPONSORKIT '88-89



LEIGH BARNARD

- A Richard and Lorna Brien
- B Lindum House
- C Residential Home
- D
- E



DAVID GEDDIS

- A TS Typesetting Unit 22
- B Cheney Manor
- C Tel: 618505
- D Compton Welding Purton
- E Swindon 770742



'CHIC' BATES

- A Mary Hewer, Take-A-Way, 49 Groundwell Rd
- B
- C Mr Julian Wilson
- D
- E A. and R. Supplies



PAUL BODIN

- A Videostop 2
- B 345 Cheney Manor Rd
- C
- D
- E Robins Out Of Town



COLIN CALDERWOOD

- A R & K Owen
- B Freisian Close, Swindon
- C Don Rogers Sports
- D Mr T Barnes
- E Ashton Keynes



TOMMY JONES

- A T. Herman, K. Bush
- B Grove, Wantage
- C Mr Julian Wilson
- D Anfield Factors Ltd
- E Tel: 513601



FRASER DIGBY

- A Alexander Insurance Services
- B Mrs Chilcott
- C 34 Ash Walk, Warminster
- D The Brown's
- E 6 Carters Close, Caterton



STEVE FOLEY

- A Jason and Duncan Malcolm
- B Newman Way, Bulford
- C Graham Mulcahy
- D Wills Club
- E Mrs Chilcott



JON GITTENS

- A
- B
- C Cliff Jones
- D Wessex Aluminium
- E



NICK HAMMOND

- A
- B
- C Allied Dunbar
- D
- E



CHARLIE HENRY

- A The Becketts
- B 33 Oakfield, Carterton
- C N. Miles, G. Timberlake
- D N. Clapham, Roy Cobey
- E Hillary Wits, C. Eley



DAVE HOCKADAY

- A Mr K. R. Chilcott
- B 34 Ash Walk, Warminster
- C
- D Transplant Ltd, Swindon
- E Mr Aldrige



PHIL KING

- A Bryant School of
- B Motoring Tel: 823421
- C A. J. Carter Co., Water
- D Engineers, Devizes
- E Tudor Carpets,



ROSS MACLAREN

- A John Tremlin, Coped
- B Hill Service Station
- C Terry Wollen
- D Wollens Off Licence
- E John Ward,



ALAN McLOUGHLIN

- A Wills Wholesale Electrics
- B Co Ltd, Swindon 514300
- C Freeze Frame Video
- D Production
- E Suppliers of Videos



KEVIN MORRIS

- A Barrie Saunders, 101
- B Stratton Rd, Swindon
- C
- D Mr. M. Earle
- E I. Graham, 11 Quex



TIM PARKIN

- A
- B Raynor
- C J. R. and Sons
- D Vehicle Dismantlers
- E Broadtown



ANDY ROWLAND

- A Andrea Peglar, The Old
- B Vicarage, Kempsford
- C Mrs. Weavers, Haydon
- D Wick, Swindon
- E Mrs. B. Hillier,



DUNCAN SHEARER

- A
- B
- C Peter Day
- D Bookmakers
- E



JOHN TROLLOPE

- A
- B
- C Sir Seton Wills
- D and Family
- E



STEVE WHITE

- A
- B
- C Multisets Ltd.
- D For all your
- E computer stationery

Key: A = Shirt, B = Boots, C = Track Suit, D = Training Shoes, E = Shorts and Socks

50 plus? Then reward yourself with up to a 30%
Tel: Swindon 618158, and

COUNTY GROUND

Marketing

by Doug Buswell

SWINDON TOWN F.C. VIDEOS

Videos of this evenings
game can be obtained,
cash with order, from:
The Commercial Dept,
Swindon Town F.C.
County Ground, Swindon
V.H.S.
Collected £10.00
Posted £11.25

★ ★ ★

THE INFLATABLE ROBINS

Now available from
The Robins Corner
The Commercial Dept.
The North Stand Kiosk
£4.50

*Only a few left,
purchase yours now.*

★ ★ ★



GRAND END OF SEASON RACE NIGHT

Rendezvous Club
16th May 7.30 p.m.
6 Races + 1 Crazy Goal
Tickets £5.00
to include supper.
Available from Swindon
642984 ext 30, 31 & 32

★ ★ ★

Swindon Sony Centre Player of the Month March



Well done
Colin Calderwood
who will receive his
award from Mr. Jonathan
Secker, Manager of The
Swindon Sony Centre

Introducing TODAY'S SPONSORS

Todays Match Sponsor is:
McLEAN HOMES
SOUTH WEST LTD.

The Directors of
Swindon Town F.C.
would like to express their
gratitude to

McLean Homes South West Ltd.
for their generosity in
sponsoring tonights match.

TODAY'S MASCOT



Name Debbie Stagg
Age 15 Years
Favourite team Swindon Town
2nd favourite team Liverpool
Favourite player Colin Calderwood
Favourite other player Fraser Digby

reduction in the cost of household insurance.
ask for the 50 Plus Policy.

THE CHAIRMAN

Speaking

BRIAN HILLIER

TRAGEDY

The recent scenes at Hillsborough were horribly reminiscent of the Heysel Stadium tragedy four years ago as death and sorrow engulfed the recent F.A. Cup Semi-final between Liverpool and Nottingham Forest.

Our sincere heartfelt feelings are extended to the bereaved and their friends. Results at matches have no foundation in the wake of such appalling loss of life. The F.A. Cup will have lost its meaning for this season. A barrage of questions were immediately asked and those answers can only be given in the light of a public enquiry.

This latest soccer tragedy renews the question of safety at soccer grounds. Certain aspects of the safety of sports grounds will be under scrutiny. All that we can hope is that we will never see a repeat of such a tragic loss of life.

NOT SUCH A GOOD DEAL

Our re-admittance to Europe for the 1990-91 season is seen as a victory. The point that everyone appears to have missed is that the yard-stick for English football Clubs will be judged by those who follow the England National team.

Between June and December of this year our National team play matches in **Denmark, Sweden, Poland and Holland.** We have to hope those matches are played without the backcloth of violence. We could also qualify for the **1990-91 World Cup Finals** in Italy – presuming England's results are good enough to take us there. So the suitability of Clubs to return to Europe will be judged by the behaviour of fans following these matches! Surely one English Club admitted for a test case next season would have been more appropriate?

AN OFFER TO JON

We have recently made an offer to Jon Gittens which we hope will persuade him that his future lies here at the County Ground. Jon has indicated that he wanted to negotiate with the Club and we have made him what we consider to be a fair offer.

Negotiations are always a long and delicate process but you as our regular supporters can be assured that we have made every effort to negotiate with players whose contracts have almost expired. We have been successful to date and we sincerely hope that



Jon will determine his future by staying at the County Ground.

WELCOME PALACE

I would like to welcome Crystal Palace to the County Ground this evening and congratulate them on their recent fine run of results. It is no secret that Palace have enjoyed their matches against Swindon Town since we returned to the Second Division. Results have certainly favoured the Selhurst Park Club.

Steve Coppell is regarded as one of the finest young Managers in the country and I am sure that Steve has enjoyed taking Crystal Palace to the brink of the First Division. A Division in which he graced the playing arena for many seasons with Manchester United.

A CORRECTION

May I take this opportunity to correct a printing error in our last programme versus Watford.

Would you please note that Superintendent Mike Rogers of the Wiltshire Constabulary said: **DO USE car parks near to the ground.** My apologies to Michael and we hope you will adhere to his instructions aimed at helping the local residents who have suffered inconvenience on matchdays.

**Hill House Hammond –
Lower rates for lady drivers.**

Sun Ray Heating Plumbing & Heating Engineers



The Right Result Every Time

Telephone: Swindon 695186
Morley Street, Swindon, Wilts. SN1 1SG

De Luxe Car Hire



- * OVER 100 CARS TO CHOOSE FROM INCL. AUTOMATICS.
- * SPORTS AND PRESTIGE CARS AVAILABLE.
- * NO MILEAGE CHARGE.
- * DELIVERY & COLLECTION SERVICE.
- * CHILD SEATS, ROOF RACKS & TOW BARS AVAILABLE.
- * OPEN 7 DAYS 9am – 6pm.

11 MARLBOROUGH ROAD

SWINDON 644996 (DAYTIME)
SWINDON 31205 (EVENINGS)



BAMPTONS



STRATTON ROAD,
SWINDON,
WILTSHIRE.

TEL: (0793) 35547/8/9

MOTOR VEHICLE ACCIDENT REPAIR SPECIALISTS

Approved by Major Insurance Companies



AKERS GARAGE LTD.

MAIN VAUXHALL/OPEL BEDFORD DEALERS

CAR/VAN SALES NEW & USED

Service Department M.O.T. Testing Station

BODY & PAINT REPAIR SHOP

Genuine Vauxhall / Opel / Bedford Spares

SELECTION QUALITY USED VEHICLES

AKERS

YOUR LOCAL VAUXHALL/OPEL/BEDFORD SPECIALIST

THE STREET, MOREDON, SWINDON SN2 3ES

Tel: (0793) 23457-8-9



SERVICE - PARTS - SALES - SERVICE - PARTS - SALES - SERVICE - PARTS - SALES - SERVICE

VAUXHALL - OPEL - BEDFORD - VAUXHALL - OPEL

VAUXHALL - OPEL - BEDFORD - VAUXHALL - OPEL

NOTICE BOARD

WILTSHIRE CONSTABULARY CRYSTAL PALACE SUPPORTERS WELCOME TO SWINDON

To ensure your enjoyment of what promises to be a good afternoon's football, the Swindon Police are asking for your co-operation following the final whistle.

This means remaining quietly in your enclosure until home fans have left the area of the ground - probably a wait of some five to ten minutes. This will allow you to leave to board your coaches or get to your cars without interference. As a word of advice to supporters, the removal of favours - i.e. Scarves, Rosettes etc., is a sensible precaution.

Coaches will be parked nearby as you leave the ground and Police Officers will be present to answer any queries. We may escort supporters to the Railway Station. Would train travellers please gather at the rear of the car park adjacent to the County Ground Hotel after the game.

Above all, we ask that you are patient if faced with any delay after the match. Your coach or train will not leave without you and the Police arrangements have been made to help you.

TRAVEL CLUB NEWS

Swindon Town Travel Club will be running coaches to the forthcoming matches:-

29/4

Depart 11.15 a.m.

Wallsall

Fare £4.50

13/5

Depart 9.15 a.m.

Oldham Athletic

Fare £7.50

The Travel Club Committee wish to thank all their members for travelling this season and hope they will continue to travel with us in the future. The Travel Club Annual General Meeting is to be held in the Supporters Club Function Room on Thursday 1st June at 8.00 p.m.

The Travel Club are holding a Race Night in the Rendezvous Club at 7.30 p.m. for Charlie Henry's Testimonial on Thursday 4th May. Admission by programme 50p (or on the door).

SUPPORTERS CLUB NEWS

1. Forum

Monday 8th May - Rendezvous Club 8 p.m.
Chairman/Secretary/Manager/Coach/Captain

Admission: £1 non-members 75p Supporters Club Members

2. Programme Fair

Sunday 21st May 10.20 a.m. - 2 p.m.

Supporters Social Club

Admission: 30p

Junior Robins - Free on production of Membership Card

3. Will you please send your nominations for supporter of the year to: Mr D. Smith, 12 Deburgh Street, Rodbourne, Swindon, Wilts SN2 2BX.

ANDY ROWLAND TESTIMONIAL EVENTS

on Wednesday May 10th 1989
at Blunsdon House Hotel

Tickets can be obtained at the
Reception Desk price £20.00

Guest Speaker: **Duncan McKenzie**
Testimonial Match versus West Ham

at the County Ground
on Friday May 19th 1989
Kick-off 7.45 p.m.

CHARLIE HENRY TESTIMONIAL EVENT

A Golf Challenge will be held at
Bremhill Golf Club

Teams of four

£15.00 per person inclusive of lunch
Wednesday 17th May 1989

Tee-off at 8.00 a.m.

For further information please contact Barry
Nugent (Committee Organiser) on Swindon
876484 or please leave your name and
telephone number at the Reception Desk.

Motorcyclists - keen rates for your mean machine!
Hill House Hammond Insurance Brokers Tel: Swindon 618158.

A SECOND LOOK

A LOOK AT THE SECOND DIVISION SCENE

CHELSEA JUST FAILED

Chelsea's recent defeat at Leicester City on Saturday April 15th ended their unbeaten run lasting 27 League games – and their ambition of establishing a new Club record of nine successive wins!

LEEDS REPORTED TO BE INTERESTED... NO BULL!

Leeds United are reported to have made a £1 million bid for Wolves goal machine Steve Bull.

The approach from the Elland Road Club will test the ability of the Midlands Club to hold onto the free scoring striker. West Bromwich Albion would cream off half of any transfer fee as part of the deal struck when Steve Bull joined the Molineux Club for £35,000 three years ago. The striker has scored 46 goals this season and 52 last season. Wolves have underlined their determination to keep the player by offering him a long term contract which has another two seasons to run. Leeds United have also shown a keen interest in Bordeaux's Clive Allen.

DIFFICULT TO COMPARE

Will we be able to finish in a higher position in the League table than we did in the 1969-70 season, when we finished in fifth position in the Division Two League table.

Our playing record that season read as follows:

Home						
P	W	D	L	F	A	
42	13	7	2	35	17	
Away						
W	D	L	F	A	Pts	
4	9	8	22	30	50	

Those statistics cannot be compared to this season because we now play 46 matches during the course of the season.

On the present system of three points for a win the team of 1969-70 would have accumulated a total of 67 points. The leading League goal scorer that season was Arthur Horsfield with 18 goals.

WILLING CONTRIBUTORS

Watford condemned Walsall to Third Division football at Vicarge Road last week. The fact that mattered most had nothing to do with the players of both teams. A pre-match collection among the crowd of 9,777 raised £6,800 for the families of the Hillsborough dead.

Watford Manager Steve Harrison revealed that apart from the money raised and the £5,000 given by the Club Directors, his players are organising their own contributions for the bereaved families from Merseyside.

HARRY IS DEFINITE IN HIS OPINION

AFC Bournemouth have declared fans would remain fenced in at Dean Court.

The Dean Court Club's Manager – Harry Redknapp says, "Do you think the hooligans who caused us to put up the barriers in the first place are sud-

denly going to behave?" He added, "They did not behave after the Bradford City disaster and they won't now. The fences, however much we all hate them, must remain at our ground."

Like so many Clubs AFC Bournemouth have fencing behind each goal and more wiring in the main stand to keep rival fans apart.

In our previous programme we gave you the remaining fixtures of both Crystal Palace and Watford. For your further interest the remaining matches of West Bromwich Albion, who are also one of the Clubs we are aiming to overhaul, are:

		Home		Away	
May 1st	May 6th	Portsmouth	Shrewsbury Town		
April 29th	May 13th	Crystal Palace	Hull City		

SECOND DIVISION

	P	W	D	L	F	A	W	D	L	F	A	Pts
Chelsea	42	13	6	2	45	23	13	5	3	42	22	89
Manchester City	42	12	6	3	44	24	10	4	7	24	22	76
Watford	42	14	4	3	41	17	6	7	8	26	30	71
Crystal Palace	40	12	6	2	36	16	8	4	8	26	28	70
Blackburn Rovers	42	14	4	3	45	22	5	7	9	22	34	68
West Bromwich Albion	42	12	6	3	40	18	4	11	6	21	22	65
Swindon Town	41	10	8	2	30	15	7	6	8	29	34	65
Barnsley	41	10	8	3	35	21	6	6	8	22	32	62
Ipswich Town	42	11	3	7	36	23	7	4	10	27	38	61
Leeds United	42	11	5	5	33	20	4	9	8	19	25	59
Stoke City	41	10	8	3	29	20	6	5	10	23	41	58
AFC Bournemouth	42	12	2	7	29	18	5	4	12	18	37	57
Sunderland	42	11	7	3	37	21	3	6	12	19	37	55
Oxford United	42	11	6	4	38	26	3	6	12	21	32	54
Leicester City	42	11	5	5	28	16	2	9	10	22	39	53
Bradford City	42	7	10	4	26	20	5	6	10	22	33	52
Portsmouth	42	10	6	5	30	16	3	6	12	20	37	51
Brighton & Hove Albion	42	11	4	6	35	22	3	3	15	19	39	49
Plymouth Argyle	41	10	4	6	31	18	3	6	12	18	42	49
Oldham Athletic	42	9	8	4	45	28	1	10	10	24	39	48
Hull City	42	7	9	5	31	21	4	4	13	20	41	46
Shrewsbury Town	42	4	9	8	21	27	4	6	11	15	35	39
Walsall	42	3	9	9	24	37	2	6	18	14	34	30
Birmingham City	42	4	4	13	19	33	2	7	12	9	35	29

Special rates for Retired Motorists.
Hill House Hammond Insurance Brokers.

THE UNBEATABLE TEAM

DEACONS

PLUS

ROLEX

SALES
& SERVICE



DEACONS

(Established 1848)

11-13 WOOD STREET, SWINDON

Tel: 22072 and 27530

23 MARKET PLACE, TETBURY Tel: 52766



VISA

Hulford

Motors Ltd.

SELF DRIVE HIRE SPECIALISTS
FOR OVER 30 YEARS

CAR &
VAN HIRE



SPECIAL LOW LONG WEEKEND RATES

SWINDON

34934 & 24839

SHRIVENHAM ROAD, SWINDON



SPECIALISTS IN
LTD.

*Process Pipework and Plant, Building Mechanical Services,
Industrial Fabrication, Sheet Metalwork, Combustion Services, Thermal Insulation,
Asbestos Removal, Engineering Merchants, Development Engineers*

THORNHILL, SOUTH MARSTON, SWINDON SN3 4TA.

TELEPHONE (0793) 825505 FACSIMILE (0793) 822642



CASTLE'S

Office and Bakery

4 and 5 MARKET STREET SWINDON

Telephone 522017

Specialists

Wedding Cakes, Birthday Cakes.

Try our Wholemeal Bread and

Wiltshire Lardies and

Delicious Dairy Cream Cakes

ELEGANT

Reproduction Furniture

Luxury . . .
you can afford



Qualities to suit all tastes . . .

Prices to suit all pockets . . .

Come and see for yourself at . . .

Howell's

Reproduction Furniture & French Polishing Specialists
52, DEVIZES ROAD, OLD TOWN



Swindon. Tel: 35658



JUNIOR ROBINS

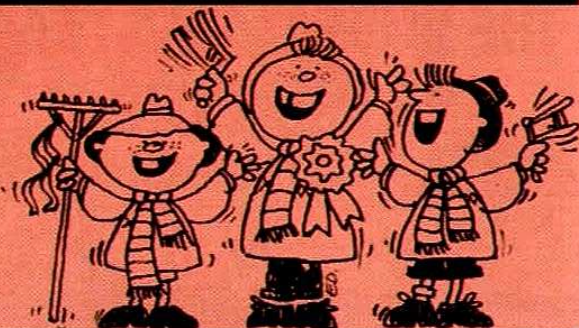

AVCO

JUNIOR SUPPORTERS DAY

What a great success the Avco Junior Supporters day turned out to be. It was nice to see that the media decided to report the good side of football which is so often missed. So thanks to Wiltshire Sound, GWR, the Evening Advertiser and BBC Points West for showing that the media does help football sometimes.

So many people to thank. John Timms and his helpers for keeping the Five-a-side competition running like clockwork. Chris Kirkland for his refereeing and after lunch talk. Ron Manners and his ladies for the much appreciated lunch, especially the chips! 'Chic' Bates, Colin Calderwood and Fraser Digby who

after a hard mornings training gave up their afternoon to run coaching sessions. Last but not least, Peter Gundrip and Avco Trust without whose sponsorship the whole event would not have been possible. We are very grateful for their generous sponsorship and for indicating they will be anxious to help us with a similar event next year.

The Five-a-side final was fought out between sides from Nythe (the eventual winners) and Wootton Bassett. I am sure this was in no small measure due to the enthusiasm of their respective Deputy Heads, Keith Embling and John Griffiths, who gave up part of their Easter Holiday to help out and encourage their pupils effort.

DEREK'S QUIZ

Derek Elston, one of Swindon's most loyal supporters, has very kindly donated a £5.00 prize for the first person to produce all the correct answers for the following quiz.

1. Name 5 League teams who's name contains the letter X.
2. Name 5 League teams who's name contains double L.
3. Name 5 League teams who's name starts and finishes with the same letter.
4. Name nine teams who's second name is only used by that Club (all Clubs have only two names e.g. Swindon Town F.C.)

OUR NEXT OPPONENTS

On Saturday next we travel to doomed Walsall who are due to return to the Third Division following their promotion of last season. The euphoria that swept Fellows Park last May following the West Midland Clubs play-off success was quickly forgotten when favourable results were hard to come by.

The feted Tommy Coakley and his assistant Gerry Sweeney, were dismissed in February and former Wolverhampton Wanderers and Notts County Manager, John Barnwell, took over the reigns at Fellows Park.

There were the inevitable incomings and departures from the Club with former Watford and Notts County striker Stuart Rimmer proving an instant success. The struggling Midland Club began to find a

semblance of improved form that would have served them well in the earlier stages of this season. It was a case of a little too late.

Andy Saville a striker who appeared here at the County Ground with Hull City joined the Fellows Park Club and formed a dual striking role with Stuart Rimmer. Both players have been in impressive form since.

The cultured play of midfield player Craig Shakespeare was the subject of varied transfer conjecture before the March transfer deadline. Reports of a £300,000 transfer move never materialised and the influential midfield player remained at Fellows Park.

One of the most attractive footballing teams to have emerged from the Third Division in recent seasons, Walsall have undoubtedly missed the goalscoring prowess of former striker David Kelly who joined West Ham United for £600,000 last summer. The Eire International's move was an unhappy outcome for not only the player but

both Clubs. The free scoring striker was unable to reproduce his form in the First Division and Walsall sadly missed his influence in the Second Division.

John Barnwell's appointment came too late to influence a dramatic change in fortunes. The prospect of a new ground and the return to the Third Division will give the Midland Club the opportunity to re-group in the Third Division and perhaps make a bid for honours once again.

The following Monday, May 1st, we entertain another of the Second Divisions struggling Clubs - Shrewsbury Town. The Gay Meadow Club who have a strong Scots clan would appear to be doomed also to the Third Division for next Season. Former County Ground favourite Brian Williams who joined Shrewsbury from Bristol City is now in charge of Youth team affairs at Gay Meadow. Both matches should offer the opportunity to add to our accumulation of points with regard to our bid to reach the end of season play-offs.

Learning to drive? Make sure of a competitive quote for your insurance. Hill House Hammond Tel: 618158.

THE CARING FACE OF FOOTBALL



Strenuous efforts are being made to provide modern facilities for the safety and comfort of all football spectators.

This year, more than £1.25 million will be spent on improvements projects at Football League grounds and areas for people with disabilities form a major part of this programme. 1989 will see further initiatives including new and better toilet facilities and additional enclosures for family support.

The Football Grounds Improvement Trust is responsible for all these measures. Each year it receives £4.5 million from the Spotting-the-Ball competition run by Littlewoods, Vernons and Zettors and spends it on schemes to improve standards at British football stadia.

MIKE KNIGHT TYRES

**SWINDONS No. 1 TYRE MAN
FOR THE BEST DEAL IN TOWN
PLEASE TRY MY TEAM FIRST**

MAIN DEALERS FOR DUNLOP, GOODYEAR,
PIRELLI, MICHELIN - PLUS COLWAY REMOULDS



BATTERY HOT LINE PLEASE RING TEL NO:

GEOFF PAGE SWIN 36023

Hundreds of 2 Year Guaranteed Batteries · Always in Stock · Ready to Fit All Cars

WESTCOTT PLACE
TEL: SWINDON 27380 TYRES
BATTERY HOT LINE: 36023
THIS DEPT TYRES & BATTERIES

TARMAC ACQUIRED
OUR RODBOURNE DEPOT
FOR REDEVELOPMENT

SHRIVENHAM ROAD
TEL: SWINDON 20629 TYRES
TEL: SWINDON 52574 EXHAUSTS
THIS DEPOT TYRES, BATTERIES, EXHAUSTS

Hill House

INSURANCE

Looking for the Right Policy?

MOTORISTS

NEW & YOUNG DRIVERS **SAVE** With our starter discount
SPORTS & GT DRIVERS **SAVE** With Lower Group Rating
FOREIGN CAR DRIVERS **SAVE** With our special scheme

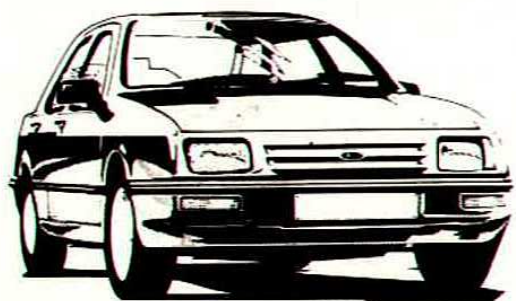

LADY DRIVERS **SAVE** Up to **25%**
MOTORCYCLISTS **SAVE** With our special scheme
MATURE DRIVERS **SAVE** With our special scheme
Motorist policies

HOUSEHOLDERS

Our special range of policies include
Home insurance with a **25%** No claims Bonus
Savings of up to **30%** for the retired or 50 Plus.

Discounts available for Neighbourhood watch
areas, Burglar Alarms, Home Security and Dog Owners

ALL TYPES OF INSURANCE ARRANGED.
MORTGAGES – LIFE – PENSIONS

(written details on request)



Hammond

E BROKERS

Policy at the Right Price?

ounts
tings
emes
%

ur high bonus Policy
our over 50

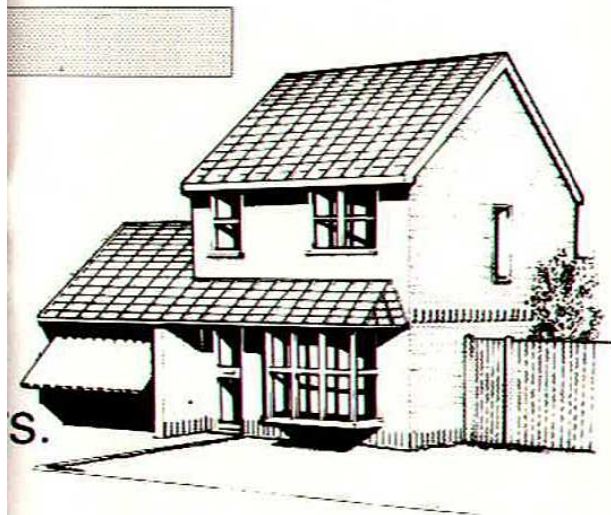

S.



FREE
COMPUTER
QUOTATIONS

SWINDON

618158

128 COMMERCIAL ROAD
SWINDON SN1 5PL



TAKING THE *Opposite* VIEW

CRYSTAL PALACE

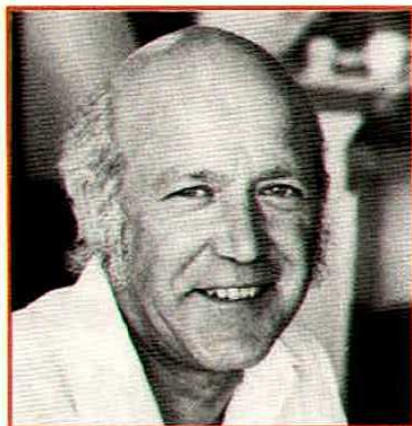

by Dave Eaton



Front row, left to right: John Pemberton, Glenn Pennyfather, Alan Pardew, Ian Wright, John Salako.

Middle row, left to right: Steve Coppell (Manager), Mark Bright, Jeff Hopkins, Geoff Thomas (Team Captain), Gary O'Reilly, David Madden, Dennis Bailey, David Burke, Ian Evans (now Swansea City).

Back row, left to right: Gavin Nobbeling (Club Captain), Phil Barber, Perry Suckling, Brian Parkin, Mark Harris, Neil Redfearn.

When Alan Mullery was relieved of the Manager's position at Selhurst Park, Crystal Palace turned to Steve Coppell to rekindle the Club's fortunes. The former Manchester United and England player, and a colleague of Swindon boss Lou Macari, had been forced to quit the game through a serious leg injury. In June 1984, at 28 years of age, he embarked on a new career. In his first season, 1984/85, he stabilised the Club's fortunes and laid the base for an assault on promotion from the Second Division.

In the following season Palace finished fifth and in the last two seasons have just missed out on both occasions of reaching the promotional play-offs. Each time they

were handily placed in the League but finally ended in sixth spot - one place away from the play-offs and only two points adrift.

This season though Palace seem certain to reach at least the play-offs and hopes are high of promotion back to the First Division for the first time since 1981.

Palace were formed in 1905 and were original members of Division 3 in 1920, and the following season gained a place in Division 2 as the Division 3 champions.

Four years later though they were relegated and remained a Third Division outfit until 1958.

They became a founder member of Division 4, but this was the beginning of

an upward trend which saw them rise from 1961 in eight years to reach the First Division for the first time. During that period they finished as runners-up in Division 4, 3 and 2.

Four seasons were spent in the top flight before they dropped back into the Second and the following year were relegated again.

They managed to regain First Division status again; when they ended the 1978/79 season as Division 2 champions.

Life in the top flight was short-lived, just two seasons. Since 1981 Palace have been members of Division 2. During Palace's history they have used several grounds, with Selhurst Park becoming their permanent home since 1924.

MEET THE MANAGER AND PLAYERS

Steve Coppell (Manager). Age 33. Born Liverpool (9.7.55). Joined Crystal Palace as Manager in June 1984 having been forced to retire from the game because of a serious knee injury. Started his playing career with Tranmere Rovers in 1973 as an amateur whilst studying for his Economics Degree at Liverpool University. Signed professional in July 74 and transferred to Manchester United in 1974/75 season. He made 320 appearances for United scoring 53 goals and won 42 England caps. He was an outstanding performer for his country and held a permanent right wing position until his injury against Hungary which led to his ultimate retirement. His book 'Touch and Go' was published last year and received excellent reviews.

John Pemberton. Age 24. Joined Palace from Crewe Alexandra during 87/88 season for £60,000. He had previously played for Rochdale. Has the ability to play in any of the defensive positions. He played alongside Geoff Thomas when they were both at Cresty

Does your dog reduce your household insurance premiums?



• Geoff Thomas

Road. Was substitute on a number of occasions last season but will no doubt be knocking on the first team door this season.

Geoff Thomas. Aged 24. He enjoyed a very successful first season, 87-88, with the Club, picking up four Player Of The Year Awards after his £50,000 signing. Previously with Crewe, but began his career at Rochdale.

John Salako. Age 20. This youngster has come through the Crystal Palace Youth side to make his first team debut in January 1987. He was a leading goalscorer while appearing for the Youth Team and was last season selected for the England Under-20 squad.

Richard Shaw. Age 20. A defender and another youngster to graduate through the Youth Scheme to first team football. A regular member of the Reserve side, he also figured in a number of first team matches last season. Made his debut in the 3-2 win at Reading.

David Madden. Age 26. Joined Palace on a free transfer from Reading during last summer. Began as an apprentice at Southampton but never made a League appearance for the Saints. Other Clubs include Bournemouth (loan), Arsenal, Charlton and Reading.

Glenn Pennyfather. Age 26. Glenn joined Palace from Southend United for £150,000, after spending almost nine years at Roots Hall. He made 238 League appearances for the Essex Club. Glenn spends his afternoons teaching in a school local to his Benfleet home.

Ian Wright. Aged 25. London born, Ian enjoyed considerable success with Palace during last season scoring 23 goals and picked up the runners-up trophy at the

end of season presentations. The main attributes of his game is his speed, fine ball control and turning ability.

Jeff Hopkins. Age 25. He joined Palace in August 1988 for a fee of £240,000 which was fixed by a League tribunal. Has appeared in both full International and Under-21 level for Wales. Prior to signing he had been previously a one club man appearing in a Fulham shirt since 1980/81, when he made his debut for the West London Club. As a central defender he made 219 League appearances for Fulham and with his move South of the River will no doubt be looking to increase his number of Welsh caps.

Eddie McGoldrick. Age 23. Born in London he began his football career at Nuneaton. Joined Northampton Town for start of the 86/87 season. Was an ever present for them in the League last season. Signed for Palace in January of this year for a fee of £200,000.

Gavin Nebbeling. Age 25. The South African made one of the centre half places his own during last season as well as getting among the goals. He was signed from Arcadia Pepsi, Johannesburg, in 1983 for £10,000 and then whilst at Palace has spent a spell on loan at Northampton Town during season 1985/86.

Gary O'Reilly. Age 28. He made his Palace debut in January 1987 in the F.A. Cup 3rd round. He is a tall strong centre half who previously played for Tottenham and Brighton and spent last summer playing in Sweden. He was signed by Palace from Brighton for £40,000.

Alan Pardew. Age 27. Wimbledon born. Alan moved to Selhurst Park in 87/88 for £7,500 from Yeovil Town and made his League debut last season. Went on to record 20 League appearances.



• Ian Wright



• David Burke

David Burke. Age 28. The Liverpool born left back moved South from Huddersfield Town during 1987 for £65,000. He had a tough baptism with Palace, making his debut in the South London derby against Millwall but came through that match and went on to be ever present in the number three shirt in that season. He is married and lives in Surrey.

Mark Bright. Age 27. The highscoring centre-forward, notched 25 goals during the 1987/88 season. He joined Palace from Leicester City in November 1986 for £75,000 after a spell at Port Vale. He struck up a fine partnership with Ian Wright last season to become part of one of the top striking partnerships around the country. Came through a serious arm injury to help Palace's push in last season's promotion race.

Phillip Barber. Age 23. He joined Palace from Aylesbury Town in 1984 and has made a number of appearances in both the centre forward and left wing positions. The £10,000 striker scored on his Palace debut against Grimsby Town. Known at the Club as 'Mr. 110%' and is a firm favourite with the Selhurst regulars.

Perry Suckling. Age 23. He joined Palace in 87/88 from Manchester City for £100,000 after spells at Coventry and a loan period at Chelsea. He has appeared for the England Under-21s on a number of occasions both at home and abroad.

Mark Harris. Age 25. A central defender he joined the Club as a full-time contract player during the close season from Wokingham Town. Last season played several matches in the Football Combination side as a non-contract player.

If the answer is no,
ring Hill House Hammond on 618158.

WALKER JACKSON

**WELCOME
TO THE MOTORING
WORLD OF**



CAR SALES · SERVICE · PARTS

· IVECO FORD TRUCKS ·

...the full Ford Range, including Rallye Sport & Iveco Ford Trucks... ...WJ - renowned
for Quality, Choice and Value for Money!...

Fleming Way
Roundabout
Tel: Swindon 20002

Car Service & Parts
Marlborough Road
Tel: Swindon 20002

Commercial Sales · Service · Parts
Coped Hall, Wootton Bassett
Tel: Swindon 853344

A Member of the Normand Group of Companies.



A SELECTION OF LEISUREWEAR IN THE 'ROBINS CORNER'

Sweatshirts (Various Designs) Prices range from	£10.50-£15.50
Polo Shirts (Red, White or Black)	£10.50
Tour T. Shirts (small number available) Reduced to	£4.50
* Inflatable Robins	£4.50
Programme Binders (now in stock)	£2.95
* Bath Towels (Club Crest). Ideal for the beach	
Summer Season Offer	£5.50
Baby Grows (6-12 months/12-18 months)	£4.50
Bibs	£0.99
Various Key Rings, Pens, Pencils, Rubbers, etc. (all in stock)	
* Club Ties (in Navy or Grey)	£5.75

* The above are all available from all Commercial outlets

TUNE IN WITH BBC WILTSHIRE SOUND'S VIC MORGAN



WELCOME

Good Evening and welcome to the County Ground, especially to those of you who have made the arduous journey around the M25. Recent games with Crystal Palace have been close affairs, we should see a fine match this evening. There's plenty at stake for both.

LITTLE TO SAY TO EASE THE PAIN

Once again death has joined those who love the game of football. There is little that can be said about the recent tragic events at Hillsborough to ease the pain of that sad afternoon. A combination of things led up to the disaster which turned what should have been a classic football match into a day of intolerable human suffering. God bless all those who suffered, it must **never** happen again.

A BUSY TIME

As we approach the end of the season it seems that the football calendar is pretty busy. Swindon's first team played three games in the last week, while the Youth side were also in action in the final of the Midland Youth Cup. The home game with Watford was a case of more points dropped to play-off rivals despite taking the lead. Not even the appearance of the inflatable robbins could force a victory. But it was a well taken goal by Steve White and for those of you who perhaps feel the Town striker strays offside more than he should, just appreciate his positional sense and the fact that he takes as

many chances as he does. After all a forward cannot score unless he's in the right place at the right time.

ROSS THIS WAS SPECIAL

As for Ross Maclaren's first goal at Birmingham, well that really was something special. While reporting from St Andrews I compared the goal to the one scored by Bobby Charlton against Mexico in the World Cup of 1966. It certainly was a tremendous effort and the Town sweeper should be rightly proud of his strike.

DEPRESSING ST ANDREWS

The win at Birmingham put Swindon back into the play-off picture at a deserted and depressing St Andrews. Birmingham of course had already been relegated and goodness me it showed in the size of the crowd, just 4,026 the lowest attendance since the War at City's ground. Those mountainous terraces were all but empty and it was a sad sight to see. Still the young City side played well in the second half and it must give them hope for the future.

WELL DONE LADS

Talking of young sides, the two on show in the First leg of the Midland Youth Cup Final at the County Ground have every reason to be pleased with the way they played. The youngsters of Swindon and Nottingham Forest put on a great show with none of the slightly seedy tendencies that have crept into the modern game.

The match flowed from start to finish and there were six goals, it all augurs well for the Second leg at the City Ground tomorrow evening.

WHAT SUMMER

The brand new cricket season has got under way and it heralds the arrival of summer. Summer? Don't make me laugh. It should be a terrific season with the tour of the Australians and the forth coming Ashes test series. England's test team has been in the doldrums of late and need a good performance against the Aussies to get the new regime of Ted Dexter and David Gower off to a good start. Whatever happens we should see some fine cricket in the next few months.

END OF THE SEASON

As one season starts another finishes and that is certainly the case with G.W.R.F.C. The final League match ended in an 8-1 defeat by M.D. Motors, a result which gave the Motors side a play-off for the Division 8 championship with S.W. Transport. We've had a few friendlies, but now it's a time to organise the end of the season dinner and talk of missed chances and missed points. Kevin Newman ended up our leading scorer, well done Kev, let's see the same next season.

So back to the matter in hand, let's enjoy a good and peaceful game of football.

Stay tuned.

**Retired? Save up to 30% on your Household Insurance with
our special policy. Hill House Hammond Tel: 618158.**

145 years of traditional ales.



Ask for Arkell's. It's full of Wiltshire flavour.

Kingsdown Brewery, Stratton St. Margaret, Swindon. Telephone: 0793 823026

ARKELL

EST & SONS 1843

FOOTBALL COMBINATION & YOUTH TEAM NEWS

LAST HOME MATCH OF THE SEASON
Our South East Counties League team completed their home Second Division programme with a 1-1 draw versus Bristol Rovers. The match was played at Lydiard Park on Saturday, April 8th.

Town Youth team Manager **John Trollope** in his report of this penultimate South East Counties League fixture said, "This, our last home match of the season, proved to be a game of contrasting halves. In the first half we produced some good football, creating some clear cut chances and we should have been deservedly ahead by three or four goals by half-time. A wasted penalty by Paul Hunt and other missed chances left **Liam Dixon's** conversion of a centre by Paul Hunt our only score at the interval."

John's description of a deteriorating second half was, "It was continually scrappy with Rovers playing a more intimidating role. We became over involved and our play consequently suffered. Bristol Rovers equalised when poor marking in defence allowed **Marcus Stewart** to equalise with a header."

John concluded by saying, "We must learn not to let teams upset the way in which we played and not to lose our composure when provoked."

Team: Lovegrove, Spalding, Graham, Quinn, Sandrey, Lea, Hammersley, R. Morgan, Dixon, Hunt, Walker.

Substitutes: Macari (for Walker in 46th min.) Murray (for Lea in 71st min.)



● **Liam Dixon** - The Town's trainee, who hails from nearby Highworth, was on the mark for our Youth team against Bristol Rovers and Slough Town.

TOWN OVERCOME THE 'SAINTS' AT THE DELL

Following their 4-0 drubbing at Wimbledon in midweek, our Reserve team returned to winning ways on Saturday, April 8th. Their 2-0 success in their 'Ovenden Papers' Football Combination match came against a Southampton team which included former Town striker **Paul Rideout**.

Town Coach **Andy Rowland** in his report of the match at **The Dell** said: "Following the midweek setback against Wimbledon we managed a clear cut two goal win. The first half was even with neither goalkeeper under any intense pressure although we had long periods of possession."

We took the lead after 65 minutes when **Fitzroy Simpson** scored with a brilliant volley into the far top corner of the net. Within two minutes **Gary Marshall** made it 2-0 with a hard low shot on the blind side of the Saints' keeper, **Tim Flowers**. Continual pressure failed to increase our lead. Overall we had every reason to be well satisfied with a very competent performance."

Team: Thompson, Fleming, Marshall, Barnard, Parkin, Cornwell, Tomlinson, Coyne, Henry, Simpson, M. Jones.

Substitutes: Summerbee (for Cornwell in 45th min.) G. Morgan.

SURPRISINGLY HELD TO A DRAW

Our Reserve team were held to a surprise draw when they met Oxford United at the County Ground on Wednesday, April 12th. The match ended with a 1-1 scoreline in this 'Ovenden Papers' Football Combination fixture.

Town Coach **Andy Rowland** in his report of the match said: "We had to come from a goal in arrears when **Paul Simpson** put the visitors ahead after only five minutes of play with a well placed shot. It was an own goal that brought the scores level when Peter Coyne's shot was deflected into the net by an Oxford United defender. David Geddis missed a good opportunity to give us the lead when his shot just cleared the crossbar. Neither goalkeeper was troubled for the remainder of the match. The game petered out into a scrappy affair with neither team doing themselves justice on the day."

Team: Thompson, Tomlinson, Marshall, Barnard, Parkin, Cornwell, Coyne, Simpson, Geddis, Henry, Viveash.

Substitutes: King (for Tomlinson in 70th min.) M. Jones (for Coyne in 45th min.)

PLAY-OFF SUCCESS

Our Allied Counties Youth League team overcame the first hurdle in their play-off



● **Gary Marshall** - The former Coventry City trainee scored the second goal in our 2-0 win at Southampton. This was the Stroud born defenders first goal of the season for our Reserves.

matches when they defeated Slough on Wednesday, April 12th by 5-1 at Hungerford Town.

Town Youth team Manager **John Trollope** said in his report of the match, "In this, our first play-off match, we were given a flying start with goals from **Richard Walker** and **Liam Dixon** in the first six minutes of play. We continued to dominate the match but we failed to turn our advantage into goals."

The second half continued in the same pattern and we turned our superiority into goals from **Martin Churchward** and **Mike Macari (2)** which emphasised our dominance. Our 5-0 lead was reduced when Slough were awarded a penalty in the dying minutes of the game."

John said in his appraisal of the performance, "A good start to the play-offs but even more important was the way in which the result was achieved. It was a fine team performance in which our play was thoughtful and constructive. This allied together with hard work and enthusiasm contributed to a highly successful result."

Team: Ryan Lovegrove, Lee Spalding, Alex Graham, Neil Quinn, Martin Churchward, Edwin Murray, Richard Walker, Paul Trollope, Mike Macari, Liam Dixon, Mark Lea.

Substitutes: Jason Braidwood (for Lea in 70th min.) Simon Payne (for Murray in 63rd min.)

Going on holiday? Ask for Travel Cover Plus.
Holiday Insurance with legal expenses backup.
Hill House Hammond Tel: 618158.

PENALTIES? YOU WON'T GET ANY AT BARCLAYS.

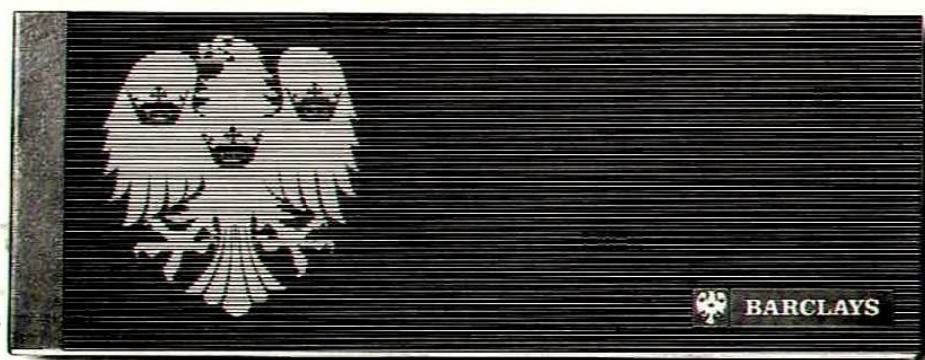

With The Barclays Bank Account you won't be charged for everyday transactions like cheques, credits and standing orders.

It has three options, two of which pay interest, and you can simply switch between them as your needs change.

Call into your local Barclays branch for further details. The Barclays Bank Account, in a league of its own.

••• YOU'RE
BETTER OFF
TALKING TO
 BARCLAYS

THE BARCLAYS BANK ACCOUNT IS A CURRENT ACCOUNT FOR PERSONAL CUSTOMERS. AN OVERDRAFT FACILITY IS ONLY AVAILABLE ON APPLICATION. INTEREST RATES MAY VARY. WRITTEN DETAILS ARE AVAILABLE FROM BARCLAYS BANK PLC, PERSONAL SECTOR MARKETING, JUXON HOUSE, 94 ST. PAUL'S CHURCHYARD, LONDON EC4M 8EJL. MEMBER OF IMRO.

NEWS NEWS NEWS

Desk Desk Desk

Remaining fixtures to be played at the County Ground

April

Wednesday 26th

Chelsea

Football Combination K-O 2.00 p.m.

Thursday 27th

Wiltshire Senior Cup

Wiltshire F.A. K-O 6.15 p.m.

Friday 28th

Junior Cup Final

Wiltshire F.A. K-O 6.15 p.m.

May

Monday 1st

Shrewsbury Town

League Division Two K-O 3.00 p.m.

Saturday 6th

Stoke City

League Division Two K-O 3.00 p.m.

Sunday 7th

U-13 Minor Cup Final

Wiltshire F.A. K-O 2.00 p.m.

Sunday 7th

Youth Cup Final

Wiltshire F.A. K-O 3.45 p.m.

Tuesday 9th

St. Josephs v Kingsdown

Under 13 Finals Schools F.A.

K-O 4.15 p.m.

Commonweal v Hreod Parkway

Under 14 Final K-O 5.25 p.m.

St. Josephs v Dorcan

Under 16 Final K-O 6.45 p.m.

Tuesday 16th

Queens Park Rangers

Football Combination K-O 2.00 p.m.

Friday 19th

Andy Rowland Testimonial

Swindon Town v West Ham United

K-O 7.45 p.m.

PRE-SEASON FIXTURES FOR THE 1989/90 SEASON

The Club is currently in the process of arranging friendly fixtures for next July and August. To date we have arranged the following:

Saturday, July 29th

Trowbridge Town.

Away, kick-off 3.00 p.m.

Saturday, August 5th

Hereford United

Away, kick-off 3.00 p.m.

(Hereford Senior Cup).

When we won the Final last season at Edgar Street we were asked to defend the trophy which we readily agreed to do.

Thursday, August 10th

Sherston F.C.

Away, kick-off 7.30 p.m.

Friday, August 11th

Reading

Away, kick-off 8.00 p.m.

INTERESTED ONLOOKERS

Former Town players **Chris Kamara** and **Dave Bamber** were among the interested onlookers at our recent match with **Birmingham City** at **St Andrews** last Tuesday, April 18th.

Chris asked our Commercial Manager **Doug Buswell** if his son could be mascot when we entertain **Stoke City** here at the **County Ground** on **Saturday, May 6th**. Both players will be hoping to line-up in the **Potteries Club** colours for this match.

THE ONLY EVER-PRESENTS

Fraser Digby and **Adrian Viveash**

are the only two players to have made maximum appearances for our two Senior teams this season. Fraser has played in each of our Second Division fixtures and Adrian in all our our Football Combination matches. Incidentally Fraser celebrated his 22nd birthday on Sunday last.

THE IRREPRESIBLE KEN

What a remarkable come-back for former Town goalkeeper **Kenny Allen**. The 37-year-old defied **Wolverhampton Wanderers** in Torquay United's 2-0 Sherpa Van Trophy win at Molineux last Tuesday. This surprising victory took the Plainmoor Club through to a Wembley Final where they will now meet Bolton Wanderers.

ANY SUGGESTIONS

We are in the process of designing next seasons programme and we would welcome any suggestions or ideas, you, the supporters, would have on what you would like to see incorporated. We cannot obviously include every idea or suggestion but if you would like to write C/o the Programme Editor, The County Ground, Swindon we will consider all ideas and suggestions. May we thank you for your anticipated interest. Please also tell us of any article you would personally wish to see retained for next seasons issue.

Special rates for Retired Motorists.
Hill House Hammond Insurance Brokers.

IN OFF THE POST

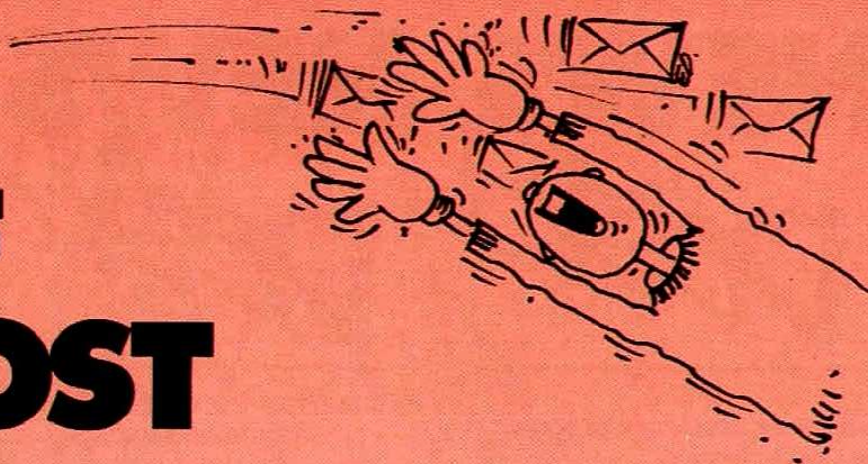

Thames View
Lechlade

To Avco and Swindon Town FC,

Thank you very much for the day we had at the County Ground on Thursday 30th March it was great to have a tour of the ground. And to sit in the dug-out and see the Boot Room. I come to all the home matches at Swindon with my Dad. My best players are Fraser Digby and Tommy Jones.

It was great to see Colin Calderwood. The Five-a-side was fun to even if we didn't do any good.

**Thank you all very much,
From Ben James**
age 8

P.S. Thanks for the lunch as well it was smashing.

Swindon Schools' Football Association
9 Chudleigh
Freshbrook
Swindon

Dear Mr King,

Would you kindly pass on to the Board of Directors the most grateful thanks of this Association for allowing us to make a collection at the County Ground before the match against West Bromwich Albion.

We raised the princely sum of £173.47 and are obviously delighted.

Sincere thanks again

Yours sincerely
John Archer

Liden School
Parent Teacher Association
Liden Infant and Junior Schools
Liden Drive
Swindon

Dear Mr King,

Thank you very much indeed for your letter of 20th February 1989 offering us an autographed matchball for use as a prize at our Summer Fayre. My husband has subsequently collected this and our Committee have decided to auction the ball at the Fayre and we are sure it will be a very competitive auction!

We do appreciate that you must receive many requests such as ours and I am therefore particularly grateful for your Club's interest in our event and for your good wishes. I will ensure that your support is acknowledged in our printed programme.

Many thanks again and here's to Division One!

Your sincerely,
Pauline Wilmer
(Secretary)

**Hill House Hammond –
Lower rates for lady drivers.**



Contractors Plant Hire

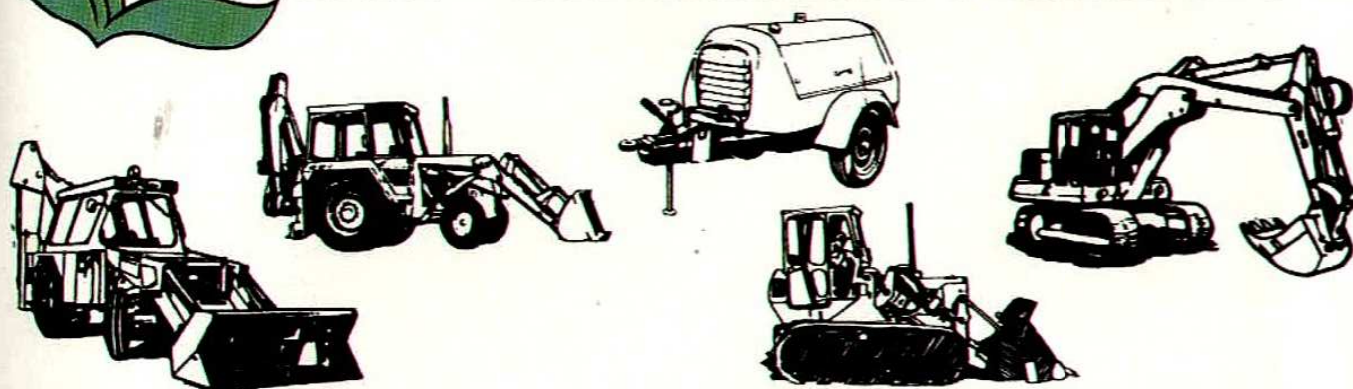

Transplant Limited

Head Office
Broad Hinton
Swindon
Wiltshire SN4 9PF
Telephone : Swindon
(0793) 73671

Reading Depot
Toutley Works,
Toutley Road,
Wokingham,
Berks. RG11 5QN
Telephone: Reading
(0734) 786278

Bristol Depot
Emery Road,
Brislington Trading Estate,
Bristol BS4 5PF
Telephone : Bristol
(0272) 779211

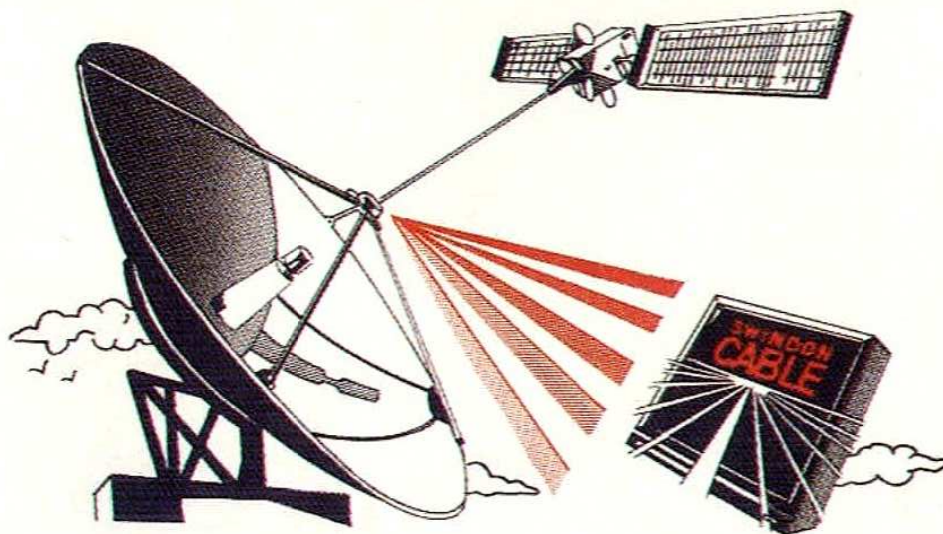

International coverage of all the major sporting favourites including;
Athletics, Golf, Rugby, Wrestling, Gymnastics, Skating, Motor
Racing and of course Football, together with live action from the
new and exciting world of Speed Sailing, Windsurfing, Baseball,
Body Building and Yachting.

plus a great deal more from

Swindon Cable – Your Local Cable & Satellite Television Company
Telephone: 0800 717121

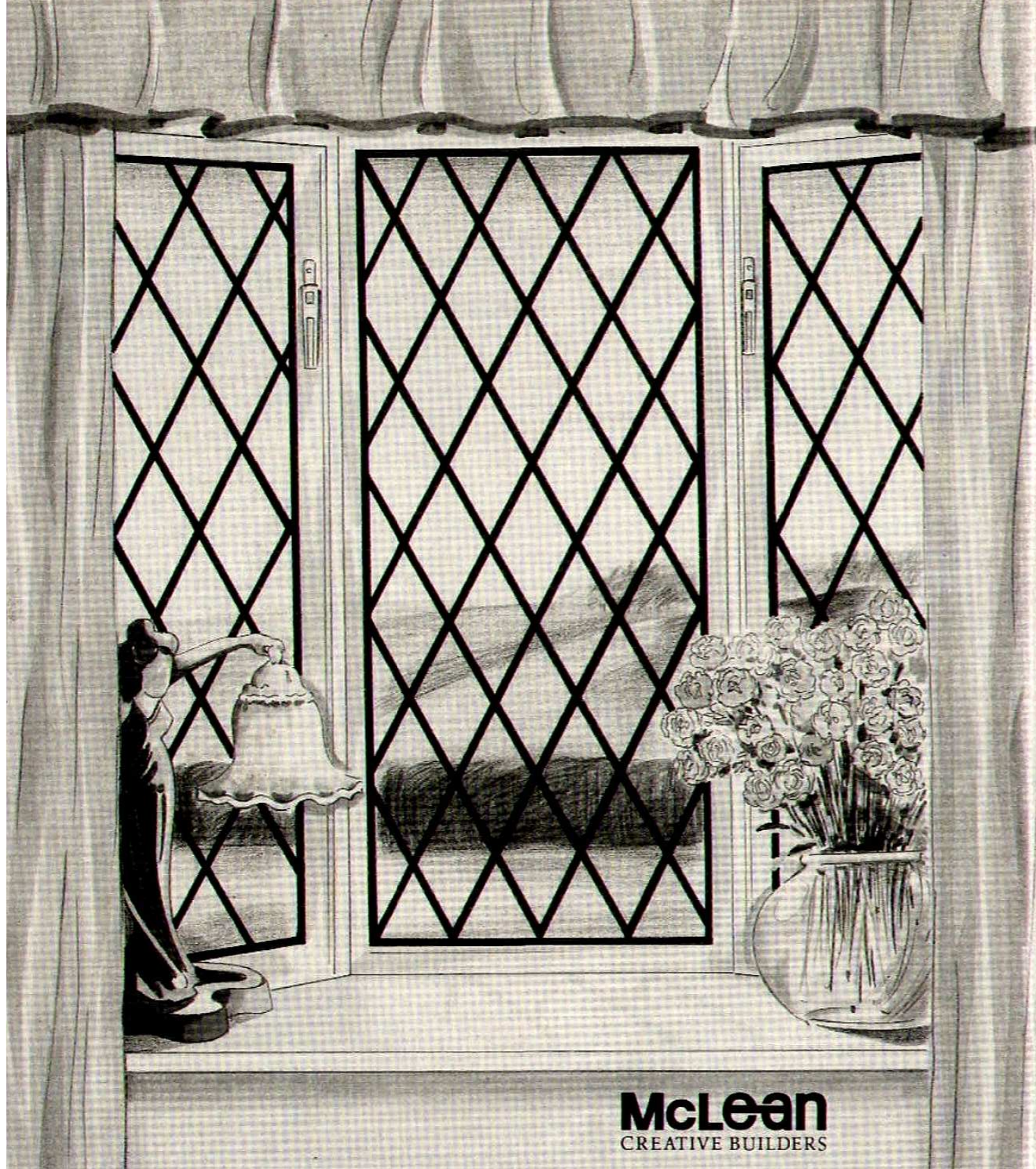

**Admit it, you're beginning
to feel at home already.**

VIEWPOINT

A MODERN AND LATTER DAY COLLECTION

I have been asked to write this weeks Viewpoint. Normally this is a column written with the view of job description or career nostalgia.

It is my intention to look at the Club from another aspect and take you through the main doors of the Club. In the most recent seasons a far greater interest has been shown in visual description of present and by-gone days. While the majority of memorabilia is of the present day there are various items depicting days of long ago and it is this aspect I would like to introduce to

THE DUBONNET CUP

A number of interesting items relating to the Club's history can be seen in the Foyer. Nestling in the corner is the Dubonnet Cup.

This trophy was won by Swindon Town in 1910 when they defeated Barnsley 2-1 in Paris. Swindon and Barnsley had been the defeated sides in the F.A. or English Cup, as it was known then, in that season. A packed crowd saw Harold Fleming score the two goals which gave Swindon victory.

HAROLD, STILL WITH HIS EYE ON THE BALL

A statue of Fleming, his eye firmly fixed on the ball in the manner of the best coaching books, stands on the other side of the Foyer.

The statue was the work of Carlton Attwood and was presented to the Club following public subscription for a memorial of Fleming after his death in 1955. Fleming is still the only player to earn a full England cap while on Swindon's books and thus his name stands in splendid isolation on the commemorative scroll presented by the F.A. on the occasion of Swindon's centenary in 1981.

RICHARD MATTICK

MORE RECENT DAYS

A couple of items reminding us of the Club's more recent triumphs can be seen between the statue of Harold Fleming and the door. There is an inscribed mirror showing the names of the players and coaching staff during the season Swindon not only won the Fourth Division Championship but also set a record to the number of League points gained by a Club in a season. Just to the left of this mirror is a picture of captain Colin Calderwood brandishing the Cannon Trophy. A cartoon picture of the players of this period who also created a Club record of consecutive home wins can be seen just to the right of the Office entrance.

CAPTAIN SUPREME

At the foot of the stairs is a picture of another of the Club's captains, Stan Harland.

Captain during the season Swindon not only won promotion but also the League Cup, 1969, he is depicted holding the Anglo Italian Trophy which Swindon won by defeating Naples 3-0 on their own ground.

REMEMBERED WITH PRIDE

The most recent addition to the exhibits in the Foyer is a small memorial plaque to Alan Fowler, William Imrie and James Olney.

Seventy five professional footballers died while serving in the Armed Forces according to Jack Rollin in his excellently researched book 'Football at War' and these three were all on Swindon's books. Alan Fowler was Swindon's leading scorer in the 1937-8 season with 15 goals. He was killed



● RICHARD MATTICK

during the fighting in Normandy in 1944 while serving in the Dorset regiment. William Imrie was a Leading Aircraftman while James Olney was in the Guards.

WHY DON'T WE HAVE A MUSEUM!

The Club has many interesting relics of its past and only a few of them can go on display to the public. It would be nice to think that one day like Old Trafford and Lords we will have our own museum to enable people to share in the wonderful heritage of our Club. Any interested sponsors for such a venture see Doug Buswell!

CAN YOU HELP

There are many items of soccer ware in Swindon, many are probably stored in cupboards and drawers or stored in an attic. Priceless to those who dwell on nostalgia! Can we ask anyone with such an item to write to me at the Club. I am having a book on the history of the Club published in the autumn months. Your items could be of pictorial interest and this record of photography could be displayed in copy within the Club. Please try to help us preserve a history we should all be proud of as Swindonians.

Hill House Hammond Insurance Brokers.
Branches Nationwide.

LOOKING AT SOME GREAT *Chots Chots Chots*

● The effervescent Garry Thompson gave the Town defence some 'Hairy Moments'. Once again he climbs the highest to reach the ball in our recent home match versus Watford.

● Steve White scores his eleventh League goal of the season when he gave us a 1-0 first half lead against Watford on Saturday April 15th.



Lowndes Lambert UK Ltd.



Sponsors of Swindon Town F.C.

HISTICS • STATISTICS •

SWINDON TOWN 1988/89												
DATE		OPPONENTS	V	Attd	Result	1	2	3	4	5	6	7
29.8.88	MON	BARNSELY	A	6,034	1-1	Digby	Hockaday	King	Maclaren	Parkin	Gittens	McLoughlin
3.9.88	SAT	WEST BROM	A	7,512	1-3	Digby	Hockaday	King	Maclaren	Parkin†	Gittens	Bodin
11.9.88	SUN	PORTSMOUTH	H	11,443	1-1	Digby	Hockaday	King	Maclaren	Calderwood	Gittens	Foley (1)
17.9.88	SAT	BLACKBURN ROVERS	A	7,622	0-0	Digby	Hockaday	King	Maclaren	Parkin	Calderwood	Foley
20.9.88	TUE	A.F.C. BOURNEMOUTH (7.45)	H	8,055	3-1	Digby	Hockaday	King	Maclaren (1)(p)	Calderwood (1)	Gittens	Foley
24.9.88	SAT	BRIGHTON & HOVE ALBION	H	6,585	3-0	Digby	Hockaday	King	Maclaren	Calderwood (1)	Gittens	Foley
27.9.88	TUE	CRYSTAL PALACE (7.45) (LCC1)	H	7,064	1-2	Digby	Hockaday	King	Maclaren	Parkin	Gittens	Foley
1.10.88	SAT	WATFORD	A	11,657	3-2	Digby	Hockaday	King	Jones (1)	Parkin	Gittens	Foley
5.10.88	WED	OXFORD UNITED	A	9,398	1-1	Digby	Hockaday	King	Jones	Parkin (1)	Gittens	Foley
9.10.88	SUN	CHELSEA	H	11,927	1-1	Digby	Hockaday	King	Jones	McLoughlin	Gittens	Foley
12.10.88	WED	CRYSTAL PALACE (8.00) (LCC1)	A	6,015	0-2	Digby	Hockaday	King	Gittens	Henry	Jones	Foley
16.10.88	SUN	LEEDS UNITED	H	9,234	0-0	Digby	Hockaday	King	Jones	Parkin	Gittens	Foley
22.10.88	SAT	SUNDERLAND	A	13,520	0-4	Digby	Hockaday	King	Jones	Parkin	Gittens	Foley
26.10.88	WED	LEICESTER CITY (7.45)	A	9,754	3-3	Digby	Hockaday	King (1)	Jones	Parkin	Gittens	Foley
29.10.88	SAT	BIRMINGHAM CITY	H	6,937	2-1	Digby	Hockaday	King	Jones	Parkin	Gittens	Foley
5.11.88	SAT	HULL CITY	A	5,192	0-1	Digby	Hockaday	King	Jones	Parkin	Gittens	Foley
9.11.88	WED	NORWICH CITY (SIMOD CUP)	A	5,014	1-2	Digby	Hockaday	King	Maclaren	Parkin	Gittens	McLoughlin
12.11.88	SAT	IPSWICH TOWN	H	7,246	2-3	Digby	Hockaday	King	Jones	Parkin	Gittens (1)	Foley
19.11.88	SAT	STOKE CITY	A	9,339	1-2	Digby	Hockaday	King	Jones (1)	Parkin	Gittens	Foley
26.11.88	SAT	WALSALL	H	5,328	1-0	Digby	Hockaday	King	Jones	Parkin	Calderwood	Foley (1)
3.12.88	SAT	SHREWSBURY TOWN	A	3,626	1-0	Digby	Hockaday	King	Jones	Parkin	Calderwood	Foley
10.12.88	SAT	OLDHAM ATELETIC	H	5,540	2-2	Digby	Hockaday	King	Jones*	Parkin	Calderwood	Foley
17.12.88	SAT	BRADFORD CITY	A	9,462	2-2	Digby	Hockaday	King	Jones	Parkin	Calderwood	Foley
26.12.88	MON	PLYMOUTH ARGYLE (3pm)	H	7,883	1-0	Digby	Hockaday	King	Jones	Parkin	Gittens	Foley
31.12.88	SAT	MANCHESTER CITY	H	10,776	1-2	Digby	Hockaday	King	Jones	Parkin	Gittens*	Foley
2.1.89	MON	PORTSMOUTH	A	11,681	2-0	Digby	Hockaday	King	Jones	Parkin*	Calderwood	Foley
7.1.89	SAT	PORTSMOUTH (FA Cup R3)	A	10,582	1-1	Digby	Hockaday	King	Jones	Cornwell	Calderwood	Foley (1)
10.1.89	TUE	PORTSMOUTH (FA Cup R3)	H	11,457	2-0	Digby	Hockaday*	King	Jones	Calderwood	White	Foley (1)
14.1.89	SAT	BARNSELY	H	10,201	0-0	Digby	McLoughlin	Bodin	Jones	Calderwood	Cornwell	Foley
21.1.89	SAT	CRYSTAL PALACE	A	8,109	1-2	Digby	McLoughlin	Bodin	Jones	Calderwood	Cornwell	Foley (1)
28.1.89	SAT	WEST HAM UTD. (FA Cup R4)	H	18,627	0-0	Digby	McLoughlin	Bodin	Jones	Calderwood	Gittens	Foley
1.2.89	WED	WEST HAM UTD. (FA Cup R4)	A	24,723	0-1	Digby	McLoughlin	Bodin	Jones	Calderwood	Gittens	Foley
5.2.89	SUN	OXFORD UNITED	H	10,227	3-0	Digby	Hockaday	Bodin	Jones	Calderwood (1)	Gittens	Foley
11.2.89	SAT	CHELSEA	A	17,802	2-3	Digby	Hockaday	Bodin(1)	Jones	Calderwood	Gittens	Foley (1)
18.2.89	SAT	SUNDERLAND	H	7,432	4-1	Digby	Hockaday	Bodin	Jones	Calderwood	Gittens	Shearer (2)
25.2.89	SAT	LEEDS UNITED	A	22,651	0-0	Digby	Hockaday	Bodin	Jones	Calderwood	Gittens	Shearer
28.2.89	TUE	LEICESTER CITY (7.45)	H	7,456	2-1	Digby	Hockaday	Bodin	Jones (p)	Calderwood	Gittens	Foley
4.3.89	SAT	IPSWICH TOWN	A	11,542	2-1	Digby	Hockaday	Bodin	Jones	Calderwood	Parkin	Shearer
11.3.89	SAT	HULL CITY	H	7,090	1-0	Digby	Hockaday	Bodin	Jones	Parkin	Calderwood	Foley
18.3.89	SAT	A.F.C. BOURNEMOUTH	A	9,752	3-2	Digby	Hockaday	Bodin	Jones(1)	Parkin	Calderwood	Foley(2)
25.3.89	SAT	WEST BROM	H	12,240	0-0	Digby	Hockaday	Bodin	Jones	Parkin*	Calderwood	Foley
27.3.89	MON	PLYMOUTH ARGYLE	A	8,487	1-4	Digby	Hockaday	Bodin	Jones(1)	Gittens	Calderwood	Foley
1.4.89	SAT	BLACKBURN ROVERS	H	8,220	1-1	Digby	Hockaday	Bodin*	Jones	Calderwood	Gittens	Foley (1)
4.4.89	TUE	BRADFORD CITY (7.45)	H	6,476	1-0	Digby	Hockaday	King	Jones	Calderwood	Gittens	Foley
8.4.89	SAT	MANCHESTER CITY	A	22,663	1-2	Digby	Hockaday	King	Jones	Calderwood	Gittens	Foley
15.4.89	SAT	WATFORD	H	9,828	1-1	Digby	Hockaday	King	Jones	Calderwood	Parkin	Foley
17.4.89	TUE	BIRMINGHAM CITY (7.30)	A	4,026	2-1	Digby	Hockaday	King	Jones	Parkin	Calderwood	Simpson
22.4.89	SAT	BRIGHTON AND HOVE ALBION	A	9,510	2-0	Digby	Hockaday	King	Jones	Calderwood	Parkin	Foley(2)†
25.4.89	TUE	CRYSTAL PALACE	H									
29.4.89	SAT	WALSALL	A									
1.5.89	MON	SHREWSBURY TOWN	H									
6.5.89	SAT	STOKE CITY	H									
13.5.89	SAT	OLDHAM ATHLETIC	A									

50 plus? Then reward yourself with up to a 30%

Tel: Swindon 618158, and

STATISTICS • STATIST

8	9	10	11	12	14	Match Sponsor	Ball Sponsor
Calderwood	Shearer	White (1)	Barnes	Henry*	Bodin		
Calderwood	Shearer*	White (1)	Barnes	Henry*	Coynes†		
Bodin*	Shearer	White	Barnes	Henry*	Barnard	Bluebird Toys PLC, Swindon	Roy Warren and Family, Lambourn
Gittens	Shearer	White	Barnes	Henry	Bodin		
Parkin	Shearer*	White†	Barnes (1)	Henry†	Bodin*	Myson Heating Ltd. Travis and Arnold PLC	The Blunsdon House Hotel
Parkin	Shearer	White (1)	Barnes (1)	Henry	McLoughlin	Texaco Ltd., Swindon	Kissocasion, Male/Female Kissograms 870806
Calderwood*	Shearer (1)	White	Barnes	Henry	Jones*	Wheelies Ltd., Signal Way, Swindon	David Marchant, 16 Mears Drive, Shaw, Swindon
Calderwood	Shearer (1)	White*	Barnes (1)	Maclaren	Henry*		
Calderwood	Shearer	White	Barnes	Maclaren	Henry		
Calderwood	Shearer (1)	White	Barnes*	Maclaren	Barnard*	Arkells Brewery	Emery McLaven Orr
Calderwood	Shearer	White	Barnes*	McLoughlin	Barnard		
Calderwood	Shearer*	White	Barnes	Maclaren	Henry*	Mr. C. Puffert, Multi Agg Quarries Ltd.	David Norcliffe and Ben Ryan
Calderwood*	Barnard	White	Barnes	Henry*	Maclaren		
Calderwood	Henry (1)	White (1)	Barnes	Maclaren	McLoughlin		
Calderwood	Henry*	White (2)	Barnes	Geddis*	McLoughlin	Clanion Shoji (UK) Ltd.	Mr Ron Franklin, The Rat Trap, Swindon
Calderwood	Henry	White*	Barnes	Maclaren	Shearer*		
Calderwood	Henry	White (1)	Barnes*	Bodin	Shearer*		
Maclaren	Henry (1)	White	Barnes	Calderwood	Shearer	Skurveys Ltd., Drove Road, Swindon	J. Tremlin, Coped Hill Service Station
Calderwood	Henry	White	Barnes*	Geddis	Shearer*		
White	Henry	Maclaren	Geddis	Shearer	Barnes	The Plumb Centre, Swindon	Carters Supermarket, Faringdon
White*	Henry†	Maclaren	Geddis (1)	Shearer*	Simpson†		
Maclaren	Henry (1)	Barnes	Geddis	Shearer	White*	McLean Homes South West Limited	Punch Press Tooling Ltd., Faraday Rd, Swindon
Shearer (1)	Henry	Maclaren	Geddis (1)	Gittens	McLoughlin		
Shearer (1)	Henry	Maclaren	Geddis	White	Calderwood	Brothers Petroleum, Fairford. Allied Dunbar	Cliff Jones, Wessex Aluminium
White (1)	Henry	Maclaren	Shearer	Cornwell*	Barnes	M.S. Group, Wholesale News and Books Dist.	South Marston Country Club
Shearer (1)*	Geddis (1)	Maclaren	Cornwell	White*	Henry*		
Shearer	Geddis	Maclaren	Henry*	White*	McLoughlin		
Cornwell	Shearer(1)†	Maclaren	Geddis	Henry†	McLoughlin*	Tenoo Industries Group	Anfield Factors Ltd. & Jenco Ind. Services
White	Henry*	Maclaren	Geddis	Barnard	Simpson*	Travis and Arnold PLC, A Harman and Son	Mr G Groombridge, Bath Road Garage
Gittens	Henry	Maclaren	Geddis	Barnard	Simpson		
Cornwell	Henry*	Maclaren	Geddis	Hockaday*	Parkin	Transplant Ltd & Wheelies of Swindon	Our friends from the Disabled Enclosure
Cornwell	Hockaday*	Maclaren	Geddis	Henry*	Parkin		
White	McLoughlin(1)	Maclaren	Cornwell	Parkin	Henry	Oxford and Swindon Co-Operative Society	Hale & Hutchings Masonry. (0793) 727355
White	McLoughlin	Maclaren	Cornwell*	Parkin	Geddis*		
McLoughlin(1)	White(1)	Maclaren	Simpson*	Henry*	Parkin	Dreweatt Neate, Chartered Surveyors	Auto Electrix, Swindon S11 643
McLoughlin	White	Maclaren	King	Parkin	Geddis		
McLoughlin	Shearer(1)	Maclaren*	White	Henry	King*	The Holiday Inn, Swindon	Mr. G. Williams, The Ring Cafe, Cavendish Sq.
McLoughlin*	White(2)	Maclaren*	Foley	King*	Geddis		
Shearer(1)	McLoughlin	Maclaren	White	King	Henry	Burmah Petroleum Fuels Limited	Mr Raynor, Unimill Engineering, Swindon
Shearer	McLoughlin	Maclaren	White	King	Geddis		
McLoughlin	Shearer	Maclaren	White	King*	Geddis	Action Plant Ltd.	C.H. Baxter and Son, Wholesale fruit and veg
Shearer	McLoughlin	Maclaren	White	King	Geddis		
Shearer	McLoughlin	Maclaren	White	Simpson*	Henry	Roy Allen Supplies, Swindon	Wilson Tool International Ltd.
Shearer(1)	McLoughlin	Maclaren	White	Bodin	Geddis	Metalite Engineering Ltd., Swindon	Elmina Envelopes, Commercial Stationers
Shearer(1)	McLoughlin	Maclaren	White	Geddis	Viveash		
Shearer	McLoughlin	Maclaren	White(1)	Geddis	Simpson	Crosby Doors Ltd., Swindon	Keith Lodge Industrial Roofing, Malmesbury
Shearer	McLoughlin	Maclaren(2)	White	Geddis	Gittens		
Shearer	McLoughlin	Maclaren	White	Gittens	Simpson†		
* and † denotes substitute and player substituted						McLean Homes South West Limited	Coun. Jim Cordon, Mayor of Thamesdown
						F Green and Son, Coal Merchant, Lambourn	Mr A Done
						Real Fire Heating Centre, Swindon 612060	Miss Helena Chadwick

reduction in the cost of household insurance.
ask for the 50 Plus Policy.

SHORT & SWEET

THE MAGNIFICENT FIVE

Five British Clubs have won the European Cup they are Glasgow Celtic, Manchester United, Nottingham Forest, Liverpool and Aston Villa.

SPACE AGE TIME AT IBROX

Glasgow Rangers have unveiled an £11 million facelift for their Ibrox Stadium. The capacity will be increased from 44,000 to 52,000 - half of whom will be housed in a new £7 million space-age main stand. Rangers aim to raise £7 million from public funding. Another £2 million will come from the sale of the Clubs training ground.

GIOVANNI AND THE U.S.A.

Inter Milan Manager Giovanni Trapattoni has been offered \$11 million to help the United States of America automatically qualify for the finals.

HOLD ON, I MIGHT BE ON MY WHITE CHARGER

Crisis Club Darlington have recently been given £50,000 by Middlesbrough's leading shareholder. Although Henry Muskovich holds £300,000 worth of Boro shares, he says doesn't want to join the Darlington Board of Directors at this stage.

WOR KENNY IN THE MONEY

Newcastle United defender, Kenny Wharton, earned an estimated £80,000 on April 3rd when 20,899 turned up for his testimonial at St James Park. United drew 2-2 with a Kevin Keegan XI.

TURNING THE CLOCK BACK

Third Division leaders Wolverhampton Wanderers are to play a pre-season friendly against Moscow Dynamo on Tuesday, August 8th. The match will revive memories of the two meetings of the Clubs in 1955 when over 55,000 watched Wolves win at Molineux in a game which helped to launch floodlit soccer in this country. A crowd of 80,000 saw the match in Russia.

BURY HIM, JOCK

Jock Wallace, Manager of struggling Colchester United, is becoming desperate to find a way of keeping his team in the League. Jock recently called one of his players over to him and told him to follow him onto the pitch. The lad walked up and down behind the craggy Scot before asking: "What are we looking for boss?" "That bloody hole you disappear down between three o'clock and 4.40," snarled Wallace.

JOE'S IN CHARGE

Warrington's Joe Worrall will referee the F.A. Cup Final on May 20th. The 43-year-old was recently named for his second big Wembley date. Joe was in charge of last season's Littlewoods Cup Final.

TEN YEARS REWARD

Everton Captain, Kevin Ratcliffe, obtained his reward for 10 faithful years at Goodison Park recently when he collected £50,000 from his testimonial match against Athletic Bilbao. A crowd of 13,021 watched the match against the Spaniards managed by former Everton Manager Howard Kendall.

A LOU AT THE SPORT OF KINGS

Former England Captain Kevin Keegan was assaulted by a horse lout when attending Doncaster races on Saturday, April 1st. The lout was arrested leaving Kevin to return to his Spanish home muttering about the hooligan element at what was once the Sport of Kings.

OLD TRAFFORD RECORDS

The attendance of 55,040 that watched the Quarter Final F.A. Cup tie between Manchester United and Notts Forest beat the record receipts of £221,399 created by the visit to Old Trafford of Juventus in 1984. The attendance was also the largest at Old Trafford since the visit of Liverpool in September 1984.

PLEASE GO!

Brighton sacked 41-year-old chief ball boy Keith Cuss recently because he headed the ball into the crowd during the Goldstone Clubs recent 2-1 win over Manchester City. Angry Keith Cuss said: "I find the decision small minded and the players think it is petty."

FASH OFF TO NO 10

John Fashanu the Wimbledon striker has made friends in high places with his work off the pitch. John has the license for Admiral leisurewears operation in Nigeria, and has been invited by Mrs Thatcher to a Downing Street lunch in honour of Nigerian President Babangida.

I SPY

David Scott of L.E.P. are the backers of a London man who has invented the all seeing crossbar. He's patented two robot cameras inside the crossbar. One fish-eye lens covers from the back of the net to the six-yard line. The other lens sweeps the penalty area. The cost to any interested Club? £6,000. So far the League, ITV and Liverpool have shown no interest. We still will not know whether the ball has crossed the goal-line!

UNUSUAL DISTINCTION

Terry Dolan, dismissed by Bradford City recently, took over at Rochdale. That earned him the unusual distinction of having played for both Clubs he has been Manager of. Terry took over from Danny Bergara, who replaced Asa Hartford at Stockport County.

DID YOU KNOW?

Do you know which six Scottish Clubs begin and end with the same letter? They are Celtic, Kilmarnock, East Fife, East Stirlingshire, Dundee United and Alloa.

INFLATABLES

Inflatables are now the rage. Shall we see inflatable babies at Queens Park Rangers, blown up championship trophies at Manchester United. We just hope fans will stop short of representing their Club nicknames in plastic or Northampton Town may incur the wrath of Mary Whitehouse!

THE TOPS - BUT ONLY A SMALL INCOME FROM FOOTBALL

Football provides only 18 per cent of Wembley's income. It was voted the International Venue of the Year last year - something that anyone who had suffered a football match there would have found impossible to believe.

WATCH OUR VIDEO PLEASE

Norwich City plan to send U.E.F.A. a video which shows that Carrow Road, where the arrest rate is 0.003 per cent of their total attendance, is a safe place to watch football.

THE NEWSPAPER TV CRITIC WHO SAYS IT'S A BORE

The Daily Telegraph introduction to the recent Littlewoods Cup Final: 3.00 Luton v Nottingham Forest, from Wembley. A cup final must surely provide more pleasure than the sorry level of this season's live matches, with their shapeless, back passing remnant of what used to be a joy, even an art. A goal in the first half is a miracle.

**Bonus 25 - House and Contents Insurance with a
15% No Claims Bonus. Hill House Hammond Tel: 618158.**

THE WESSEX CONSERVATORY.

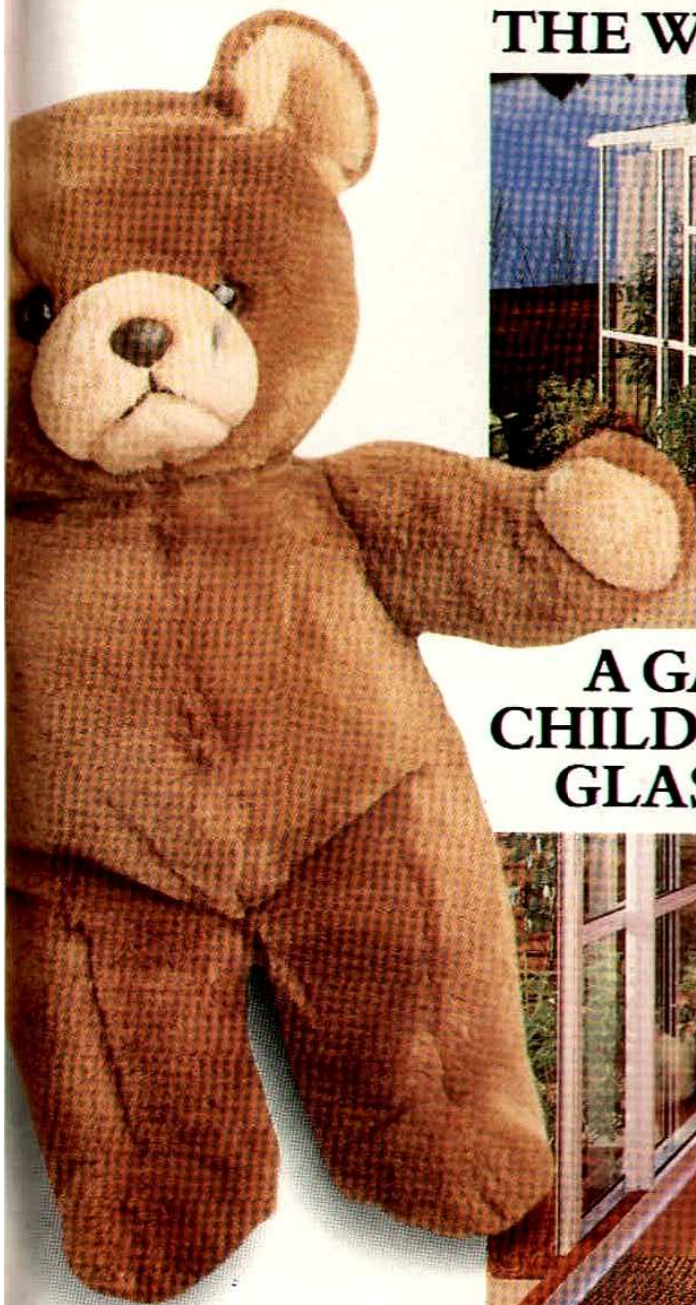

A GAMES ROOM FOR THE CHILDREN WITH TOUGHENED GLASS FOR SAFETY'S SAKE.



Yes, a Wessex Conservatory is a superb place for children to play.

Not just because it's light and airy but, with toughened glass, it's as safe as houses.

It also makes an extra living room for all the family.

A room that needs the minimum of maintenance because it never needs a lick of paint, just the occasional wipe.

And, because it has a unique glazing system, it controls ventilation and keeps the weather at bay.

Another unique feature, a glass treatment called "Clear-Shield," not only makes the glass easy to clean but also helps it stay clean.

What's more, they carry a ten year guarantee and they're also made to measure.

You see, we specialise in making individual conservatories and never toy around to convert standard models.

Most people can see through that little game.

So, for further details, contact Wessex Aluminium Limited, Hawksworth, Swindon SN2 1TT. Telephone: (0793) 644633.

WESSEX
CONSERVATORIES

Tailor-made by the specialists

TEAM CHECK

SWINDON TOWN

Team Changes

1. Fraser Digby
2. Dave Hockaday
3. Phil King
4. Tommy Jones
5. Tim Parkin
6. Colin Calderwood
7. Fitzroy Simpson
8. Duncan Shearer
9. Alan McLoughlin
10. Ross Maclaren
11. Steve White
12. Jon Gittens
14. Charlie Henry

CRYSTAL PALACE

Team Changes

1. Perry Suckling
2. John Pemberton
3. David Burke
4. David Madden
5. Jeff Hopkins
6. Gary O'Reilly
7. Eddie McGoldrick
8. Alan Pardew
9. Mark Bright
10. Ian Wright
11. Phil Barber
12. John Salako
14. Richard Shaw

Match Sponsors:
**McLean Homes South West
Limited**

Coun. Jim Cordon, Mayor of
milke Thamesdown is your
Match Ball Sponsor



TEAM IN THE MIDDLE

Referee: Mr. P. W. Vanes
Linesman Red Flag: Mr. S. W. Dunn
Linesman Yellow Flag: Mr. J. Williams
Reserve Official: Mr. A. F. Pidgeon

NEXT AT HOME

'OVENDEN PAPERS'
FOOTBALL COMBINATION
Wednesday April 26th 1989
CHELSEA



WARNING TV SURVEILLANCE

This ground is equipped with
**CLOSED CIRCUIT
TELEVISION**

Installed with the help of a grant from the Football Trust. It is there to increase crowd safety and to help the police. Recording facilities enable film and photographs to be taken of disorder, which may subsequently be used in a court of law. The Football Trust is funded entirely by the pools companies Littlewoods, Vernons and Zetters from their Spotting-the-Ball competition.

SPALL SPORTSWEAR LIMITED

Official Suppliers to Swindon Town
F.C. and Many Other Leading League
Clubs

DO CALL AND SEE DOUG WOODMAN AND
VIEW THE LARGE RANGE OF FOOTBALL
AND OTHER SPORTS GOODS AVAILABLE
FROM THE OFFICIAL CLUB SHOP.
OPEN 9.00 to 12.00 2.00 to 5.00 DAILY